

# POST AND BEAM

BARN • HOMES • CABINS • COMMERCIAL • AND MORE

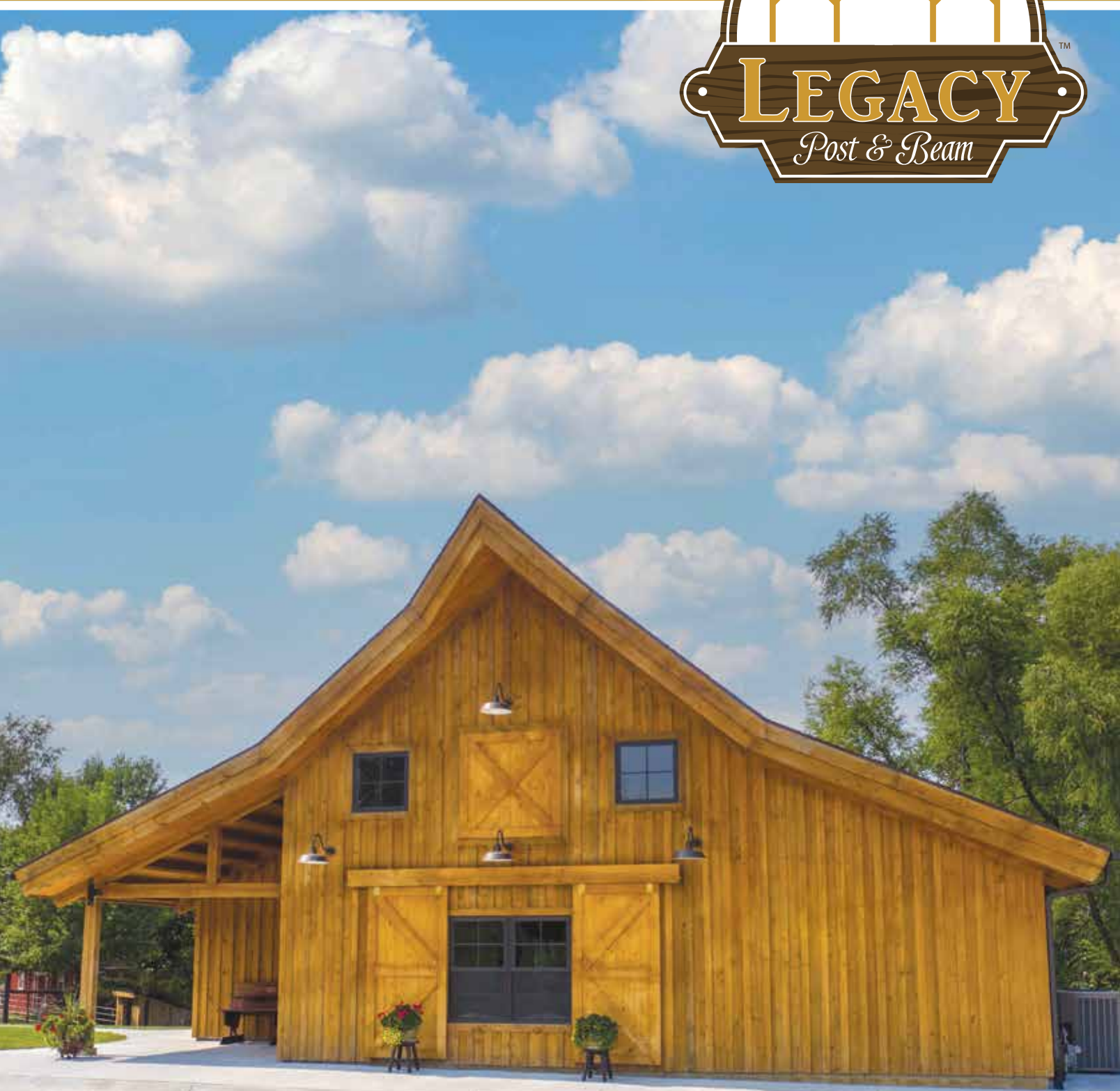

# BUILD YOUR LEGACY



**THANK YOU FOR YOUR INTEREST IN LEGACY POST & BEAM!**

Legacy Post & Beam is a family-owned company based in the Midwest that prides ourselves on offering customers across the nation with the highest quality post and beam kits available on the market.

Our company was founded out of the desire to ensure the beauty of timber frame construction was preserved in a way that was practical and cost-effective for today's consumer.

We now get to spend each day helping customers bring the building of their dreams to life, equipping them to build a legacy that will last for generations.

~ The Legacy Team

# ALL IN A DAYS WORK

Here at Legacy, we custom build post and beam kits that are perfect for barns, living spaces, event centers, commercial properties, pavilions, and more.

If you stop by our shop, you'll see fully dimensional timbers being cut to specific sizes/angles and made into bents that are pre-drilled, labeled, and then disassembled and packaged on a semi truck for delivery to the customer's site.

One of the best parts about this process is seeing customer's ideas transform into reality. We get to help them bring their post and beam project to life by drawing the plans, manufacturing the kit in our shop, and then helping them through the construction phase, whether that means connecting them to one of our network of builders, or providing advice to the general contractor/ builder of their choice.

*We love what we do day in and out, and look forward to helping you 'Build your Legacy'.*



















*"We used Legacy for our first big build project. We interviewed a number of different post and beam companies and felt that Legacy made more of an effort to listen to our needs and understand our project. Our kit build went great and we will definitely be using them for our next project."*

~Greg from South Dakota



We had the pleasure of working with Greg on his second big project, which was built in the spring of 2019!

**TABLE OF CONTENTS**

	<b>03. Barns</b>		<b>27. What's Included - Barn Kit</b>
	<b>07. Homes/Cabins</b>		<b>29. What's Included - Living Space Kit</b>
	<b>11. Commercial/Venues</b>		<b>31. Rooflines &amp; Heights</b>
	<b>15. Pavilions and More</b>		<b>33. The First Step/Accessories</b>
	<b>19. Post &amp; Beam Basics</b>		<b>35. Pre-Designed Kits</b>
	<b>21. Pre-Built Kit Overview</b>		<b>49. Featured Projects</b>
	<b>23. Top 6 Reasons To Buy From Legacy</b>		<b>73. Next Steps</b>
	<b>25. The Douglas Fir Difference</b>		<b>74. FAQs</b>

THE ICONIC UTILIZATION OF

# POST AND BEAM



Post and beam barns boast a style that is recognizable worldwide. They also serve as one of the most affordable ways to build a beautiful and authentic wood barn that will last for generations. Featuring exposed rough cut Douglas fir timbers for the strength, Legacy kits make a statement in both aesthetic appeal and practicality. They are perfect for party barns, hobby barns, barns with living space, animal barns, workshops, and more.



JKI0914



CVO1119



JRE0220



TLU0519

HOW POST AND BEAM BARNS COMPARE TO OTHER FORMS OF CONSTRUCTION

	POLE BARN	STICK FRAME	POST & BEAM (Timber Frame)	MORTISE & TENON (Timber Frame)
PRICE:	\$	\$ \$	\$ \$ \$	\$ \$ \$ \$
LONGEVITY:	✓	✓ ✓	✓ ✓ ✓ ✓	✓ ✓ ✓ ✓
AESTHETICS:	✓	✓ ✓	✓ ✓ ✓ ✓	✓ ✓ ✓ ✓



MMA0714



GW10220

### THE LEGACY DIFFERENCE

We intentionally use kiln-dried Douglas fir timbers for our structural bent framing materials and purlins. Douglas fir is the Gold Standard wood species for timber framing. Customers value this choice because it allows our projects to have longer spans and farther bent spacings than other kit providers. Additionally, the enhanced strength means less engineering upgrades as you get further along in the process. Legacy's commitment to the highest quality materials signifies our dedication to excellence every step of the way.



VJ00616



MSW0918

# RUSTIC CHARM

## MEETS MODERN FUNCTIONALITY

Our fully customizable timber frame homes and cabins feature vaulted ceilings, open floor plans, and extreme character. The exposed timbers add a signature look and charm to the living space that can be paired with drywall, or interior wood siding to create the style you're looking for. Additionally, people are often surprised to find that post and beam homes are very competitive cost-wise to a traditionally built home.

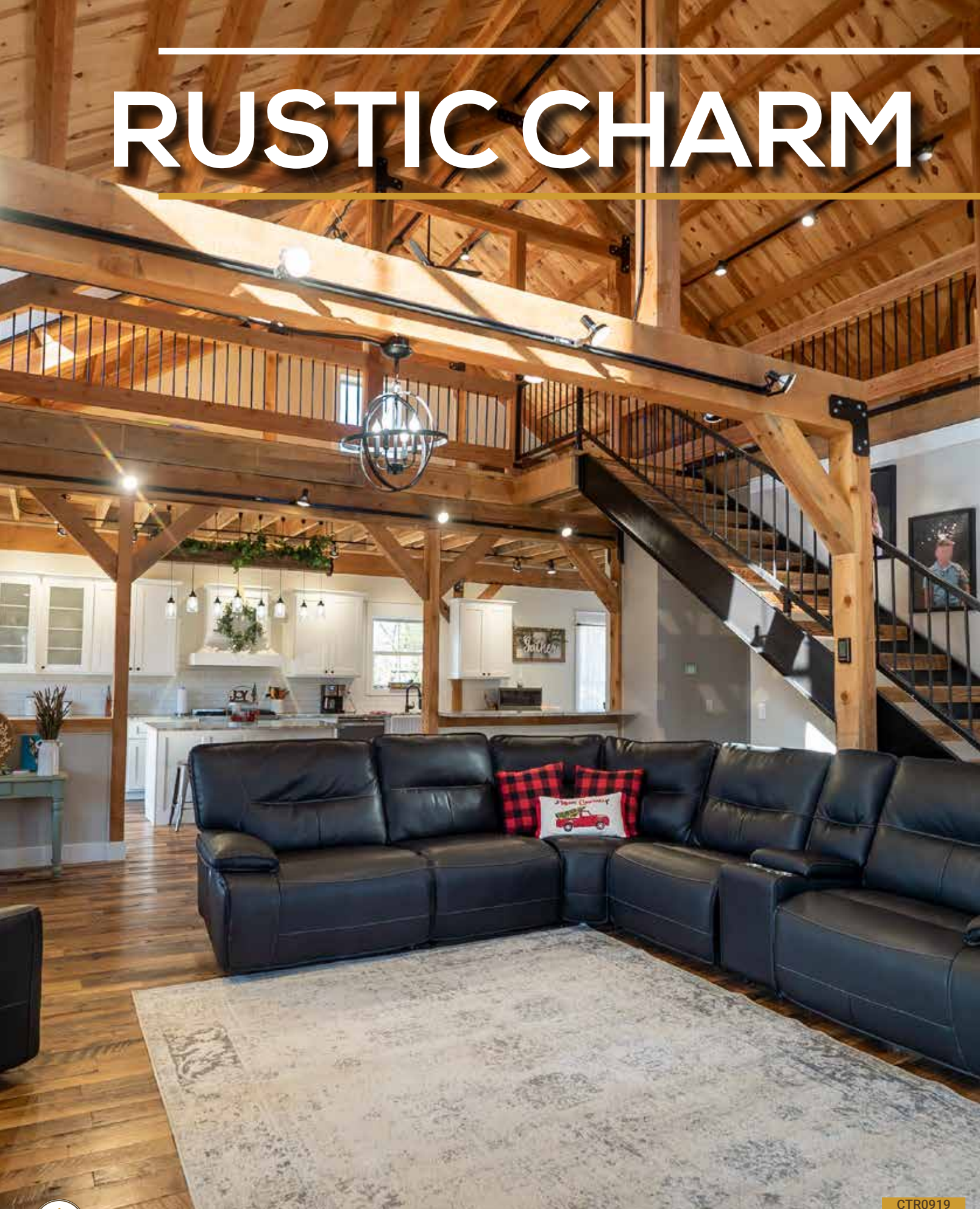

DHA0615



SWA1018



MAS0918

### HOW POST AND BEAM HOMES COMPARE TO OTHER FORMS OF CONSTRUCTION

	POLE BARN	STICK FRAME	POST & BEAM (Timber Frame)	MORTISE & TENON (Timber Frame)	LOG
<b>PRICE:</b>	Not recommended for living spaces	\$	\$ \$	\$ \$ \$ \$	\$ \$ \$
<b>LONGEVITY:</b>	Not recommended for living spaces	✓✓	✓✓✓✓	✓✓✓✓	✓✓✓
<b>STRUCTURAL MAINTENANCE:</b>	Not recommended for living spaces	👍👍👍	👍👍👍	👍👍👍	👍



CST0518

SHA0314



JM01019



DHA0615

**PRO TIP**

Post and beam offers true vaulted ceilings and open floor plans which allows for rooms to feel larger than comparable sized rooms in a stick frame home. This also generates cost savings for customers, as the total footprint of a post and beam home can be smaller than that of a stick framed home.

JEN0416



# SWEEPING OPEN FLOOR PLANS

# COMBINED WITH TIMELESS CHARACTER

Utilize the benefits of post and beam's open floor plan capabilities to compliment your commercial property needs. From lodges to wedding venues, restaurants, breweries, wineries, and more, a Legacy structure will fit your needs, budget, and provide a unique look sure to set you apart from the competition.



**PRO TIP**

A general rule of thumb for calculating venue size is to factor in 15 sq ft of space per person. For example, a venue that seats 200 people would need to be 3,000 sq ft + common spaces.





**THE LEGACY DIFFERENCE**

We go above and beyond to answer customers questions in an in-depth, informative manner. This enables each customer to make the choice that is right for them. Over time, we have found that customers value this sincere, upfront, and educational approach to how we run our business and in the end, invest in a Legacy kit.





# OPEN-AIR

## PAVILIONS, CARPORTS, AND SMALLER STRUCTURES

Add the beauty of post and beam to any property with an open-air pavilion or smaller structure.

From pavilions for an outdoor wedding/reception to backyard pergolas or even storage sheds, we are here to help turn your post and beam dreams into a reality. Our most popular items include pavilions, carports, pergolas, sheds, windmill towers, and more. Items that can fit on a standard trailer can often be delivered with the trusses assembled.



CBA0418



GTR1119



DBE0716

**PRO TIP**

Choosing a building length that is an increment of 12' is the most cost effective way to build with post and beam.



COL0517



CPA0618

### THE LEGACY DIFFERENCE

The average turnaround time on a kit is four to six months from the time a customer's deposit is placed. However, because we use kiln-dried wood, we can keep inventory of our standard timbers without fear of beams molding, twisting, or succumbing to other negative effects of storing wet timbers. This means we can produce kits much quicker if needed!



GJO0219



CHE1019



COL0517



MBA0519

Post & beam is a traditional form of construction that utilizes an interlocking heavy-timber framework for its structural support. Vertical posts and horizontal beams transfer weight to the foundation, removing the need for interior supporting walls and allowing the exposed timbers to become a visual showcase of the building.

The posts and beams are paired together to make 'bents'. Bents on our kits are typically spaced 12' apart. Since the frame is the support of the building, the interior can be finished as desired. There is no need to factor in additional load-bearing walls.

## A SINGLE BENT



## MULTIPLE BENTS COMBINED



## KEY TERMINOLOGY

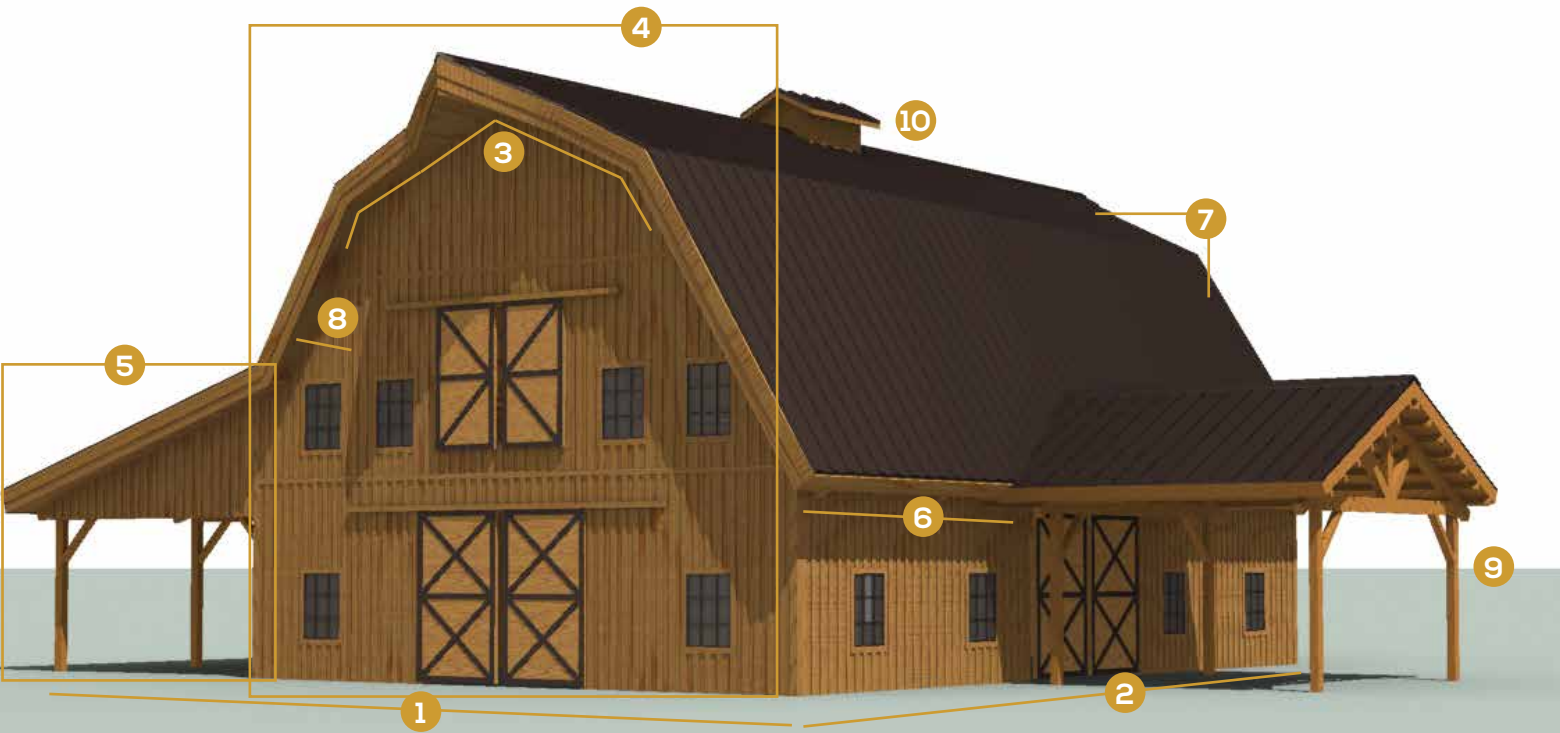

- 1 WIDTH
- 2 LENGTH
- 3 ROOFLINE
- 4 GABLE END
- 5 LEAN-TO
- 6 SIDEWALL
- 7 ROOF PITCH
- 8 OVERHANGS
- 9 GABLE ENTRY PORCH
- 10 CUPOLA

### PRO TIP

Lean-tos are a cost effective way to add space to any kit. Plus, they add variation to the roofline which adds exterior appeal.

## BENT DIAGRAM 1 1/2 STORY GABLE

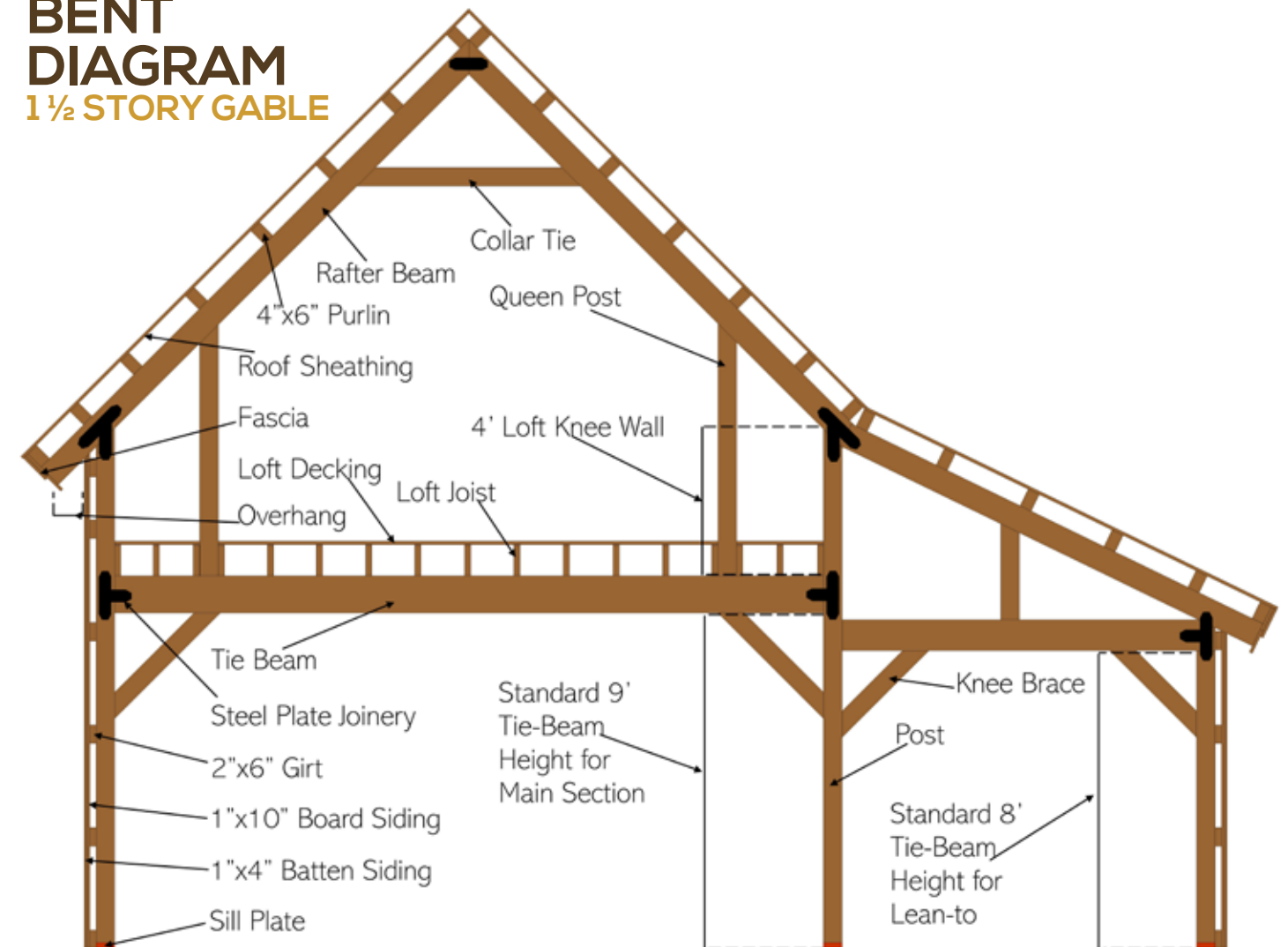



# HOW OUR PRE-BUILT KITS ARE MADE

## OFTEN TIMES PEOPLE WONDER WHAT IT MEANS TO UTILIZE A PRE-BUILT KIT

Essentially, we are doing the specialized work in our production facility and then sending the kit onsite for a builder to reassemble the structure in a simplified manner. We build each project one 'bent' at a time to ensure an exact fit. Doing this inside a controlled environment with specialized equipment allows an increased level of accuracy and precision.

## THE LEGACY PRE-BUILT KIT PROCESS

1. We start with fully-dimensional kiln-dried Douglas fir timbers
2. Our team utilizes the equipment necessary for heavy timber construction and cuts each timber down to the specific angles and lengths outlined in the final CAD plans
3. Each piece of wood is then laid in its proper position where it is marked, measured, and precision cut by our skilled craftsman to ensure an exact fit
4. The timbers are then drilled to fit our steel plate joinery
5. The bents are then labeled, disassembled, and packaged for shipment

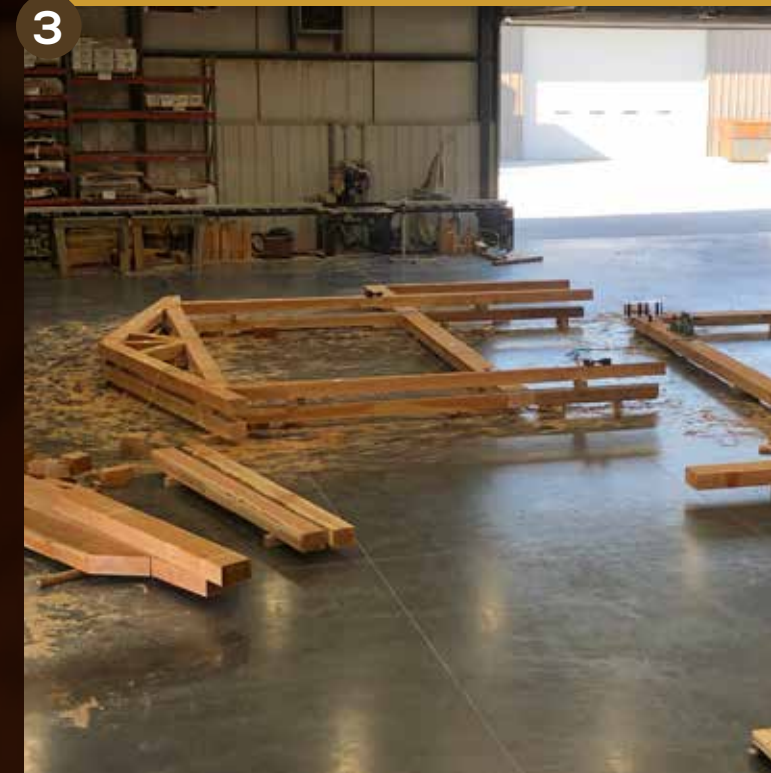

## THE LEGACY DIFFERENCE

Notice how the timber bents are wrapped. This is important in ensuring a high quality interior finish for our customers and is only possible when using dried wood. Wet wood cannot be wrapped as it can mold. Unwrapped wood is exposed to weather and dirt along transport and at the construction site. Additionally, unwrapped and exposed timbers can lead to color changes in wood due to sun exposure variance on bunked timbers.



For more benefits of our kiln-dried Douglas fir timber choice, see page 25!

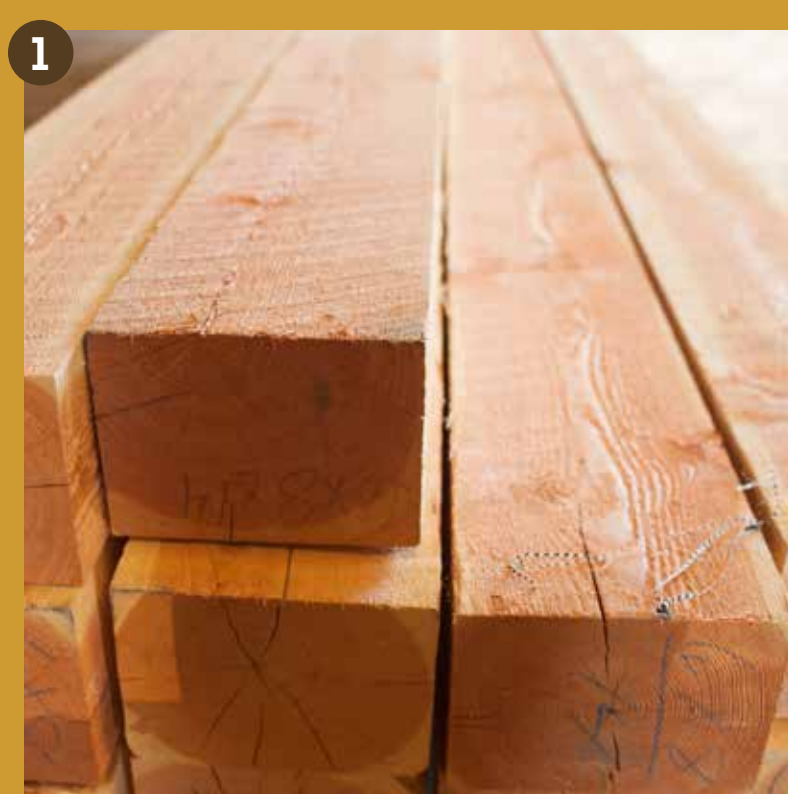

## 1. HIGH QUALITY MATERIALS

All of our kits use the Gold Standard wood choice for our structural bent work materials and purlins, kiln-dried Douglas fir. There are two important factors to consider here – first, that our wood is dried, and second the specific species selected. *Learn more about the benefits of kiln-dried Douglas fir timber on page 25!*

## 2. MORE INCLUDED IN STANDARD KIT

A base kit from Legacy includes more components than many other kit providers. We do this to ensure each kit is set-up for success from the beginning and to reduce the amount of engineering and upgrade charges needed later in the design process. In addition to our high quality wood choice, items such as 4"x6" purlins, black powder coated steel plates, 24" overhangs, and free shipping for the first 500 miles all come standard in a Legacy kit.

## 3. FAMILY OWNED WITH NATIONWIDE REACH

When you work with Legacy, you get the best of both worlds. A company that has sent kits to every corner of the US, and, a company that is small enough to be a family-owned operation that takes great pride in each and every kit we produce.

## 4. UPFRONT, FAIR PRICING

Our pricing model reflects how we do business in general – it's upfront, honest, informative, and fair from the beginning. We don't play pricing games, leave out important components, or mark kits up just to mark them down. We believe our product speaks for itself and want customers to buy when they are ready, with no surprises waiting for them down the road.

## 5. CUSTOMER SATISFACTION

When someone trusts us to 'build their Legacy' we take this responsibility seriously. It is our job to make the process as smooth and enjoyable as possible. The true mark of a job well done is a customer referral and we are honored to have much of our business come from referrals of satisfied customers.

## 6. CREATED WITH BUILDERS AND ENGINEERING STANDARDS IN MIND

We take great pride in making our kits easy to build. Saving time on the job site saves customers money and builders a headache. If you want to learn more about the extra steps we take to make this happen, give us a call to discuss. Additionally, we design our kits to meet basic International Building Code (IBC) standards from the start. This means less upgrades costs and surprises down the road. We consistently make updates to our standard kits that reflect the engineering insight we receive over the years prior as IBC codes are updated. We go the extra mile to ensure customers and builders alike have a positive experience from start to finish.

# TOP SIX REASONS TO BUY FROM LEGACY



GJ00216

## THE KILN-DRIED DOUGLAS FIR

In a timber frame kit, the choice of timber material used is extremely important! We encourage all consumers to do their research on this topic. Below are a few important reasons we have selected kiln-dried Douglas fir for our structural bent work materials and purlins and also insight into how this impacts your project.

### RESEARCH SHOWS

#### 1. DRIER IS BETTER

According to the USDA Wood Handbook:

*"Dried lumber has many advantages over green lumber for producers and consumers. Removal of excess water reduces weight, thus shipping and handling costs.*

*As wood dries, most of its strength properties increase, as well as its electrical and thermal insulating properties.*

*Properly dried lumber can be cut to precise dimensions and machined more easily and efficiently; wood parts can be more securely fitted and fastened together; warping, splitting, checking, and other harmful effects of uncontrolled drying are largely eliminated; and paint, varnish, and other finishes are more effectively applied and maintained."*

#### 2. PREMIUM CHOICE FOR TIMBER FRAME CONSTRUCTION

As stated by the Western Wood Products Association:

*"Douglas fir (DF) is often the standard against which all other framing species are measured.*

*Its strength combined with a superior strength-to-weight ratio, high specific gravity, excellent dimensional stability, the moderate decay resistance of its heartwood, and documented excellent performance record against strong forces resulting from winds, storms, and earthquakes, have given Douglas fir its reputation. It is also tight knotted and close grained, adding the bonus of beauty to its structural capabilities."*

# DIFFERENCE

### BENEFITS TO OUR CUSTOMERS

Douglas fir has a higher strength to weight ratio than other wood species which results in three key benefits to our customers.

1. Longer spans, which means less posts/more open areas and flexibility in your floor plan.
2. Less engineering upgrades are needed to pass IBC and city/county codes. This saves customers from a hefty sticker shock in the final design stages of a project.
3. Higher capacity for wind and snow loads. Our standard building plans are designed to withstand minimum wind loads of 90 mph and snow loads of 35lbs/sq ft and can be engineered to fit higher local requirements. Additionally, our base kits have passed inspection with little to no upgrades in counties requiring snow loads as high as 45lbs/sq ft and wind loads of 115 mph!



SHE0119

### PRO TIP

Utilize a king post truss upgrade to maximize the span with our kiln-dried Douglas fir timbers.



WHAT'S INCLUDED IN A

# BARN KIT

Take a detailed look at the components that make up a Legacy Post and Beam barn kit. Items in black text (in the key) are available from Legacy, either as a part of a standard kit, or upgrade option. Items in red text are not provided by Legacy but are shown for reference.

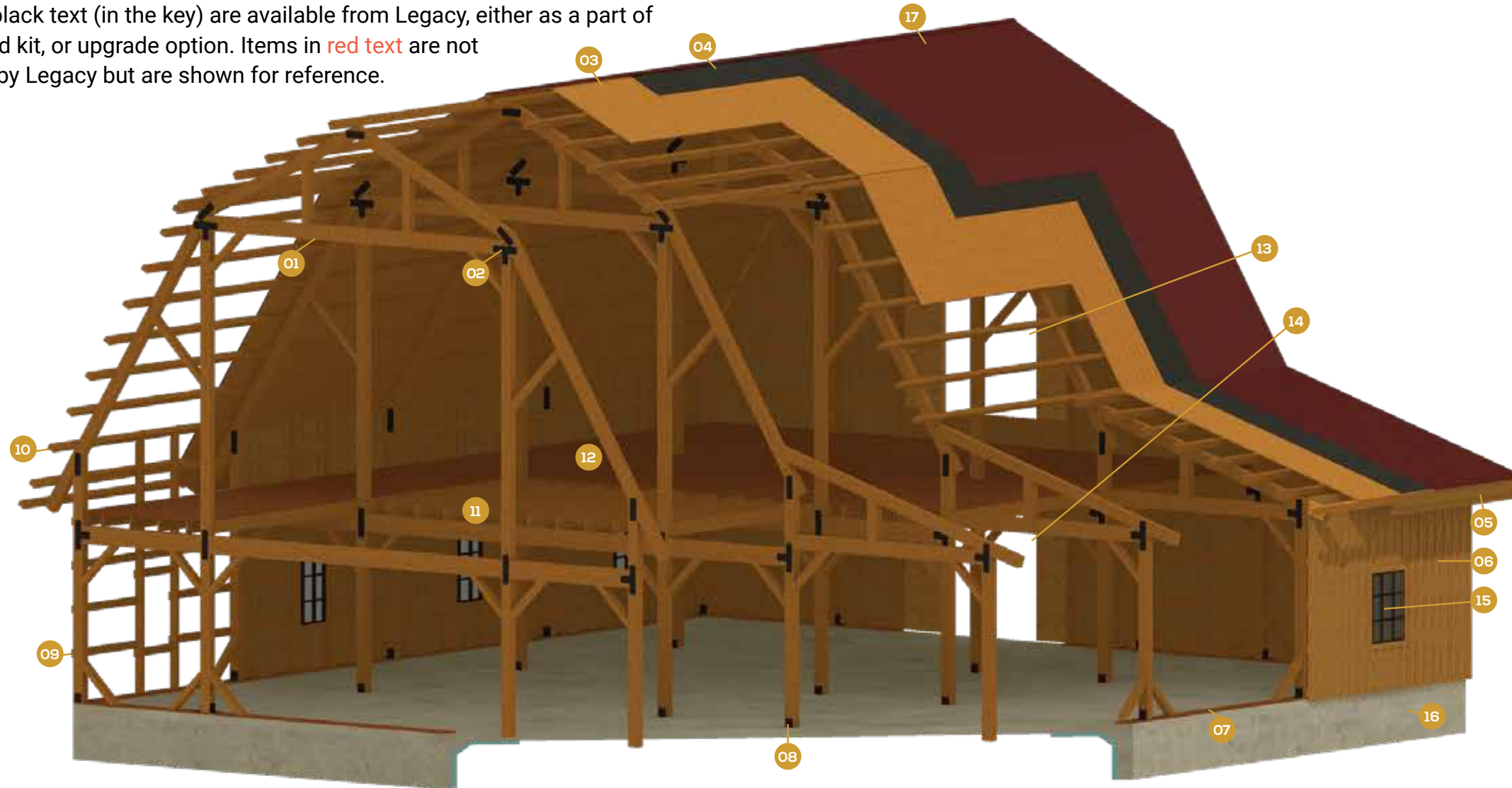

BARN KIT



## UPGRADE

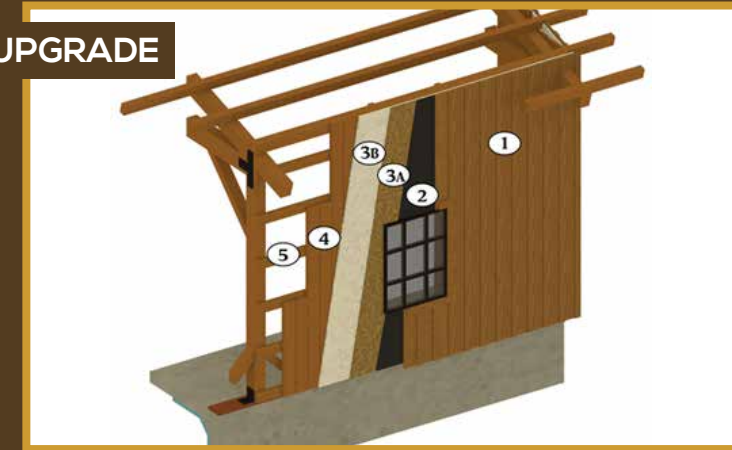

### BARN WALL INSULATION PACKAGE

1. Board & Batten Siding - Rough Cut Pine (Board - 1"x10", Batten - 1"x4")
2. Housewrap
3. 1 1/2" Foam Nailbase Panel with Screws (a. 1" Foam, b. 7/16" OSB Nailbase)
4. Tongue & Groove Interior Sheathing
5. Girt Wall Framing

## UPGRADE

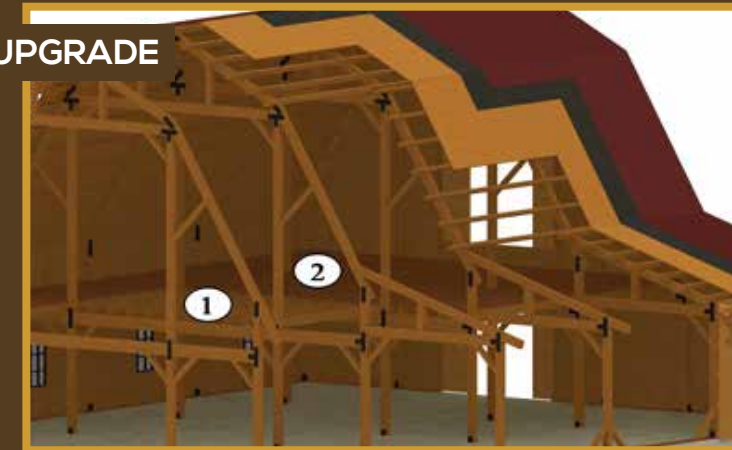

### BARN LOFT PACKAGE

1. 2"x8" Rough Cut Joist 16" OC
2. 1"x8" Rough Cut Decking

## BASE KIT

01. Bent Framing (6"x6" to 6"x12" fully dimensional are typical, kiln-dried Rough Cut Douglas fir)
02. Plate Connections (Powder Coated)
03. Rough Cut Roof Sheathing
04. Roof Underlayment
05. Rough Cut Fascia Boards
06. Board & Batten Siding - Rough Cut Pine (Board - 1"x10", Batten - 1"x4")

07. Pressure Treated Sill Plates
08. U-Brackets/Sill Brackets
09. Girt Wall Framing (2"x6" Pine wall girt framing placed 24" OC with heavy-duty girt screws)
10. Purlins (4"x6" Douglas fir roof purlins placed 32" OC with heavy-duty purlin screws)

## UPGRADES

11. Rough Cut Floor Joists\*
12. Rough Cut Floor Decking\*
13. Loft Doors\*
14. Barn Doors\*
15. Barn Windows\*
16. Foundation - configurations vary
17. Roofing Materials

\*Available as an upgrade/accessory option | Not provided by Legacy. Typical options shown for reference.

## UPGRADE



### BARN ROOF INSULATION PACKAGE

1. Upgraded Purlins to 24" OC (4"x6", Rough Cut Douglas fir)
2. Upgraded Roof Sheathing to 1"x8" T&G
3. Vapor Barrier
4. 2 1/2" Form Nailbase Panel with Screws (a. 2" of Foam, b. 7/16" OSB Nailbase) Different foam thicknesses available
5. Premium Roof Underlayment
6. Roofing Materials
7. Upgraded Fascia Boards to accommodate roof thickness
8. 1"x8" T&G Soffit Material



BUILD YOUR LEGACY



WHAT'S INCLUDED IN A

# LIVING SPACE KIT

Take a detailed look at the components that make up a Legacy Post and Beam living space kit. Items in black text (in the key) are available from Legacy, either as a part of a standard kit, or upgrade option. Items in red text are not provided by Legacy but are shown for reference.

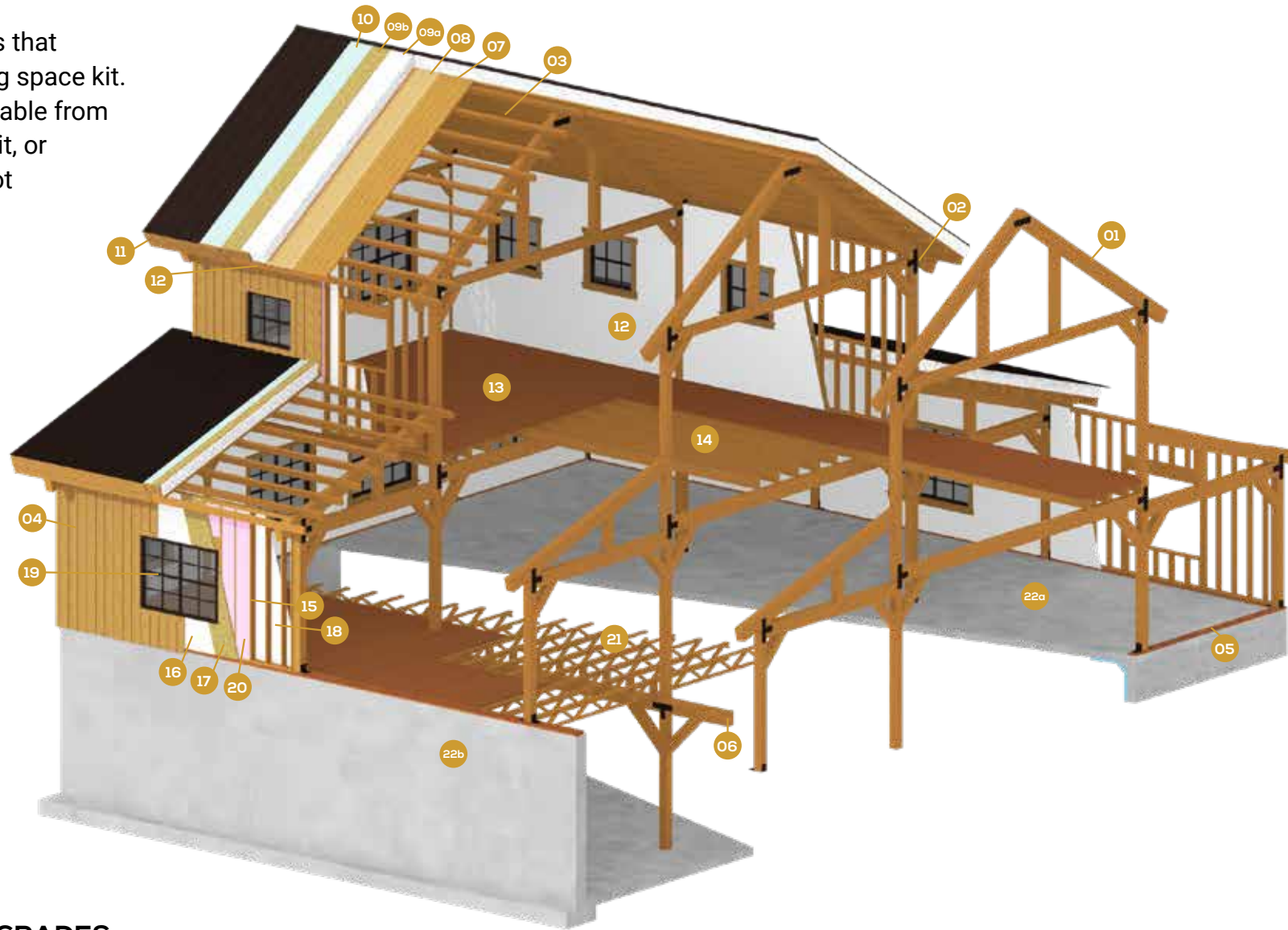

## BASE KIT

- 01. Bent Framing (6"x6" to 6"x12" fully dimensional are typical, kiln-dried Rough Cut Douglas fir)
- 02. Plate Connections (Powder Coated)
- 03. Upgraded Purlins+ (4"x6" Douglas fir roof purlins placed 24" OC with heavy-duty purlin screws)
- 04. Board & Batten Siding - Rough Cut Pine (Board - 1"x10", Batten - 1"x4")
- 05. Pressure Treated Sill Plate

## UPGRADES

- 06. Basement Girder Beam\*
- 07. Upgraded Roof Sheathing+
- 08. Roof Vapor Barrier+
- 09. Nailbase Roof Insulation Panel+ (a. Foam Insulation, b. OSB Nailbase)
- 10. Roofing Underlayment+
- 11. Upgraded Rough Cut Fascia Boards+
- 12. Soffit+
- 13. 2"x6" T&G Floor Decking\*
- 14. Rough Cut Floor Joists\*
- 15. 2"x6" Dimensional Stud Framing (16"OC)++
- 16. Housewrap++
- 17. OSB Wall Sheathing++
- 18. Drywall
- 19. Windows
- 20. Wall Insulation
- 21. Floor Trusses
- 22. Foundation - configurations vary (a. Slab-on-grade, b. Basement/Crawl Space/etc.)

+ Included with Residential Roof Package | ++ Included with Vertical Wall Framing Package

\*Available as an upgrade/accessory option | Not provided by Legacy. Typical options shown for reference.

## LIVING SPACE KIT



### UPGRADE

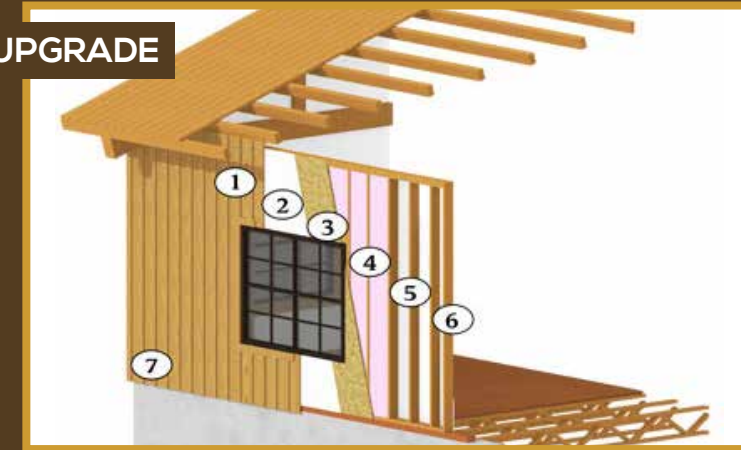

### VERTICAL WALL FRAMING PACKAGE

- 1. Board & Batten Siding - Rough Cut Pine (Board - 1"x10", Batten - 1"x4")
- 2. Housewrap
- 3. OSB Wall Sheathing
- 4. Wall Insulation
- 5. Drywall
- 6. 2"x6" Dimensional Stud Framing (16"OC)
- 7. Posts upgraded to 6"x8"

### UPGRADE

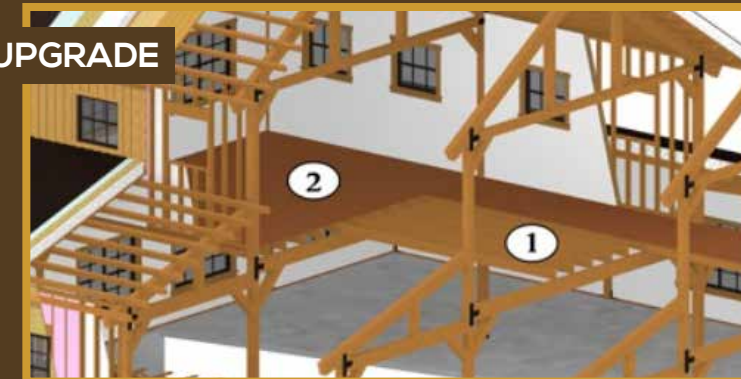

### RESIDENTIAL LOFT PACKAGE

- 1. 2"x8" Rough Cut Joists, 16" OC
- 2. 2"x6" T&G Unfinished Decking

### UPGRADE



### RESIDENTIAL ROOF INSULATION PACKAGE

- 1. Upgraded Purlins to 24" OC (4"x6", Rough Cut Douglas fir)
- 2. Upgraded Roof Sheathing to 1"x8" T&G
- 3. Vapor Barrier
- 4. 10" Foam Nailbase Panel with Screws (a. 9 1/4" Foam, b. 7/16" OSB Nailbase) Different foam thicknesses available
- 5. Premium Roof Underlayment
- 6. Roofing Materials
- 7. Upgraded Fascia Boards to accommodate roof thickness
- 8. 1"x8" T&G Soffit Material



BUILD YOUR LEGACY



# ROOFLINE & BENT OPTIONS

Each Legacy kit starts as a base model with the roofline being the focal design decision to be made up front. From there, the kits can be finished as a barn, living space, or venue depending on the upgrade and accessory options added.

## GABLE - THE ARMSTRONG SERIES

The Gable style is a traditional "A" frame that can allow continuous roofline lean-tos. You can choose a one-story or a one-and-a-half story design.



## RAISED CENTER - THE KNOX SERIES

This style allows a full second-story in the loft of the center section. Similar to the Gable, it has a typical "A" frame, but with a broken roofline when lean-tos are added.

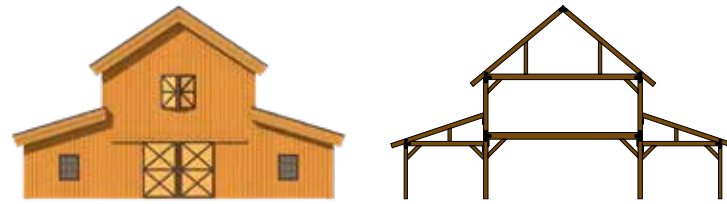

## GAMBREL - THE HUTCHINSON SERIES

This roofline has a double pitch break allowing an increased amount of space in the loft. You can choose a one, one-and-a-half, or two-story design.



## SALT BOX - THE GRAYSON SERIES

This style has an offset roofline. You can choose a one, one-and-a-half, or two-story design. A typical one-and-a-half story will give you a 4' knee wall on one side.



## COMBINATION - THE BANDERA SERIES

This option allows the look of two rooflines to be utilized. You can use any of the styles offered, although the Gable and Raised Center are the most common.



## MONOSLOPE - THE DENTON SERIES

This option utilizes a single pitch roofline, which creates a distinguished style and offers efficient design capabilities. Adjusting walls, heights, lofts, and pitches are all possible with this roofline.



If your desired roofline is not shown, please contact us to discuss how we can accommodate your needs. Note: All rooflines allow for lean-tos to be added to any side.

# STORIES/HEIGHTS

Deciding the height of your building is another key component. The main elements to evaluate are the desired heights of the tie beam, peak, and knee wall.

The **tie beam** is where the loft joists would be installed if adding a second story.

The **peak** is the highest point in the building.

The **knee wall** is what determines if the building is a one-and-a-half or full two-story structure.

It is important to note that even at the *minimum* level, a post and beam building will feel much larger than a traditional building because of the true vaulted ceilings.

## BENT DETAILS

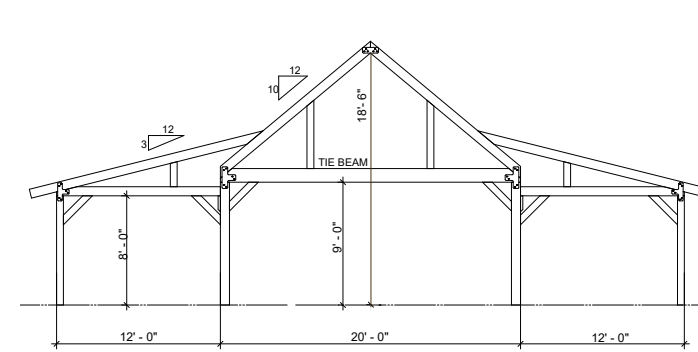

1 STORY

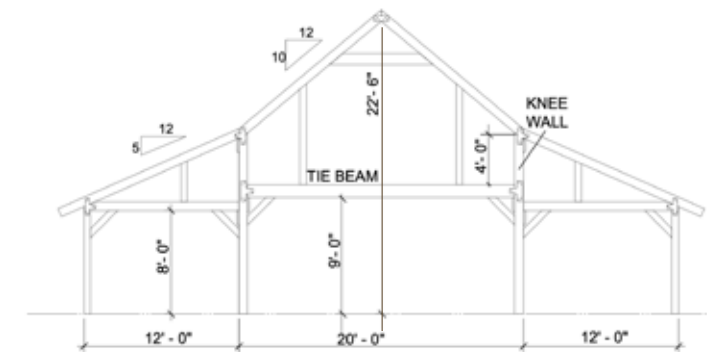

1 1/2 STORY

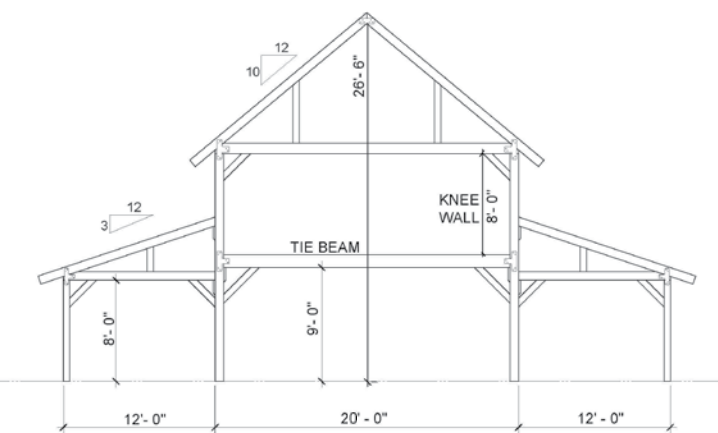

2 STORY

## TRUSS UPGRADE OPTIONS

King-Post with Struts Truss



Hammer Truss



**PRO TIP**

Upgrade your trusses to achieve further spans or create an even more distinct look. A hammer truss presents a bold beauty that can free span up to 36'. The king post truss is even stronger, enabling spans of 50' comfortably.

\*Measurement shown for reference only. Exact specs vary by project. LEGACYPOSTANDBEAM.COM 32



# THE FIRST STEP TOWARD YOUR LEGACY

One of the most common questions we hear at Legacy is **“How do I get started?”** The answer to that question involves helping us get a feel for the design, size, and use of the structure you are considering.

Sometimes our customers have very specific design ideas and may even have pictures or rough floor plans of the project they would like to build. Legacy excels at designing a kit to your specific ideas, regardless of where you get the inspiration.

It is also very common for our customers to have a general idea of what they want their project to look like, but not necessarily have specifics in mind. This is a great place to start too and reading through this catalog is a step in the right direction!

We invite you to explore the Pre-Designed Kits and Featured Projects on the following pages. These designs showcase the flexibility of post & beam kits and often serve as a starting point for discussions. Do note that the floor plans shown should only be considered as examples. All layouts are easily modified to your specific needs since there are no load bearing walls in a post & beam structure.

As you work with your Legacy Post and Beam Representative, below is a sample of the type of questions we will discuss to determine the kit that is right for you. You do not need to have all of these answers before reaching out, talking through the different options is what we do each day!

- **What will the structure be used for?** Examples: Living space, storage, ag, commercial
- **What is your preferred roofline style?** Examples: Gable, gambrel, raised center, salt-box, combination
- **What are the dimensions or square footage?**
- **What is the height?** Examples: One story, one-and-a-half-story, two-story
- **Would you like a partial or full loft?**
- **Would you like lean-tos or porches?**
- **What is your foundation type?** Examples: Slab, crawl space, basement, other
- **What accessories/upgrades would you like?** See below for our most commonly selected options.

## ACCESSORIES/UPGRADES



LOFT PACKAGES

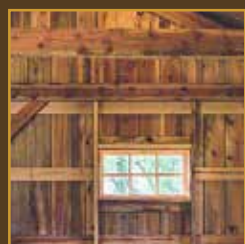

WALL FRAMING OPTIONS



STANDARD STAIR PACKAGE



LODGE STAIR PACKAGE



WIDOWS PEAK



HAYHOOD



GABLE DORMER



SHED DORMER



LATERAL BRACING



HAMMER TRUSS UPGRADE



KINGPOST TRUSS UPGRADE



CUPOLAS



SLIDING BARN DOORS



LOFT DOORS



SWINGING BARN/DUTCH DOORS



BARN WINDOWS



INTERIOR ROUGH CUT SIDING



TONGUE AND GROOVE/SHIPLAP



WOOD WINDMILL TOWER

Other Upgrades Not Pictured:

- SNOW & WIND LOAD UPGRADES
- ENGINEERING STAMP
- ROOF INSULATION OPTIONS  
Multiple thicknesses available according to preference and site specific code

## THE ARMSTRONG 3236-B

32' x 36' 1 1/2 STORY GABLE

20' Center Section with a 12' Enclosed Lean-to  
Kit Cost: \$62,212

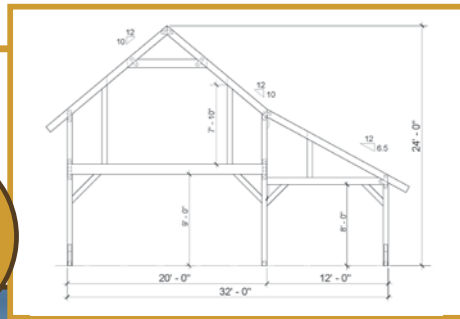

MAIN LEVEL  
SQ FT 1,152  
LOFT  
SQ FT 720

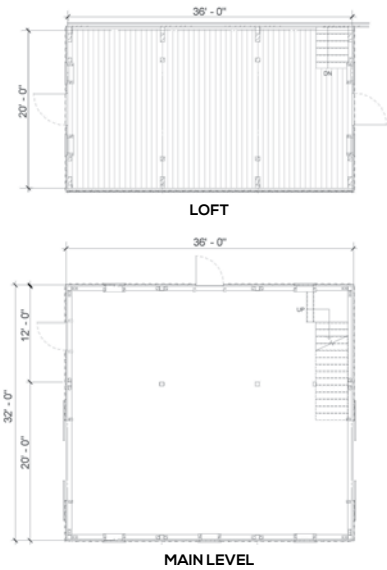

## THE KNOX 4448-B

44' x 48' 2 STORY RAISED CENTER

20' Center Section with Two 12' Lean-tos  
Kit Cost: \$99,009

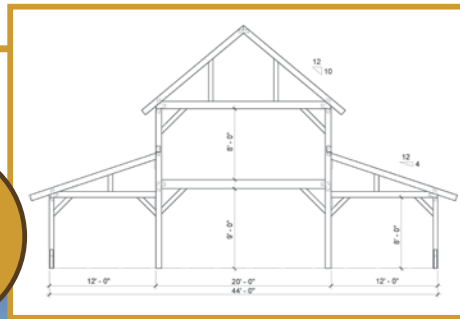

MAIN LEVEL  
SQ FT 1,824  
LOFT  
SQ FT 520

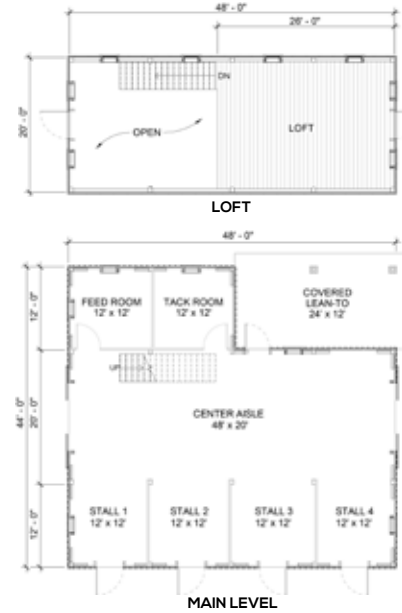

## THE ARMSTRONG 4436-B

44' x 36' 1 1/2 STORY GABLE

20' Center Section with Two 12' Lean-tos  
Kit Cost: \$81,747

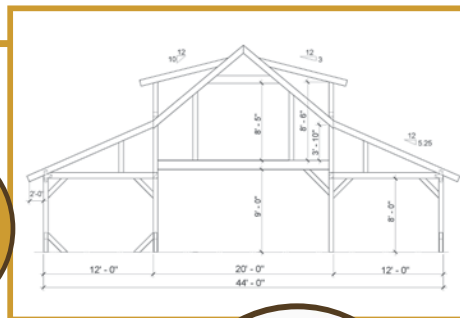

MAIN LEVEL  
SQ FT 1,440  
LOFT  
SQ FT 720

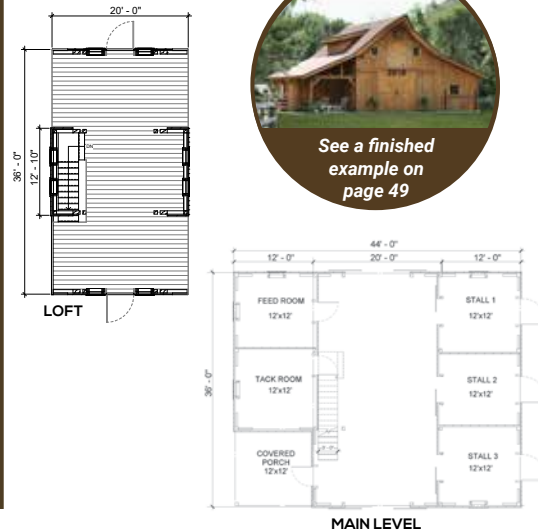

See a finished example on page 49

## THE HUTCHINSON 3448

34' x 48' 1 1/2 STORY GAMBREL

34' Center Section  
Kit Cost: \$96,898

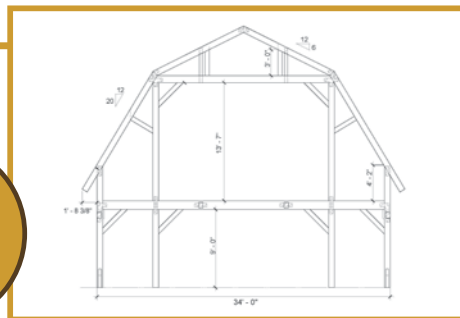

MAIN LEVEL  
SQ FT 1,632  
LOFT  
SQ FT 816

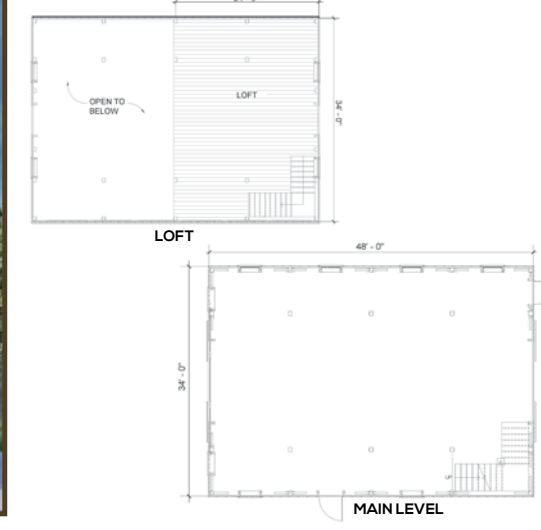



# PRE-DESIGNED GARAGE + LIVING KITS

PRE-DESIGNED KITS



## THE ARMSTRONG 2836-G

28' x 36' 1 1/2 STORY GABLE

28' Center Section with a 10' Open Lean-to Porch

Kit Cost: \$91,053

MAIN LEVEL  
SQ FT 1,008  
LOFT  
SQ FT 1,008

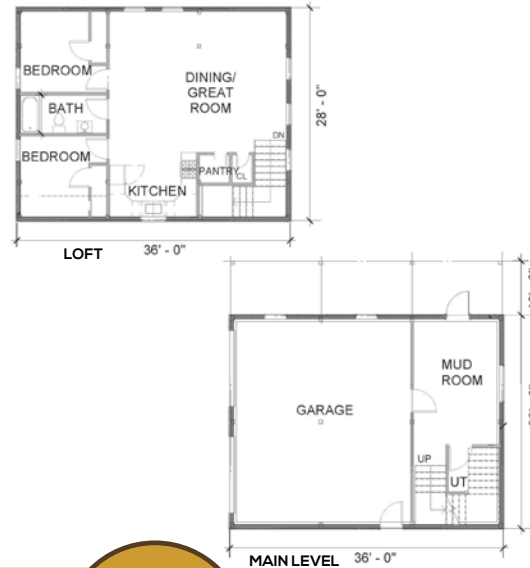
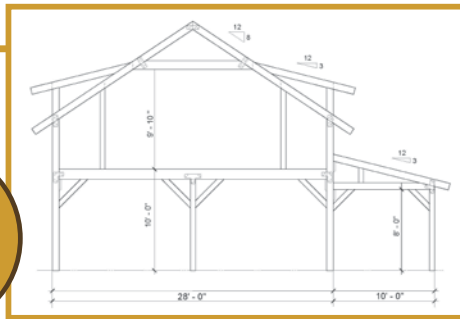

View as a full living space online: The Armstrong 2836-H

## THE KNOX 3242

32' x 42' 2 STORY RAISED CENTER

32' Center Section with 10' Wraparound Porch

Kit Cost: \$118,440

MAIN LEVEL  
SQ FT 1,344  
LOFT  
SQ FT 1,344

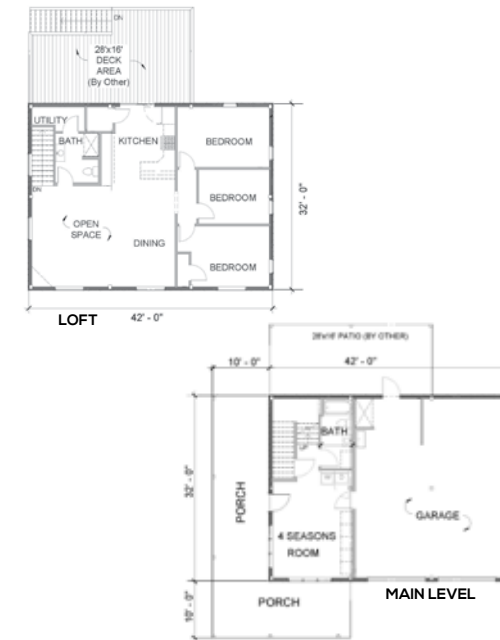
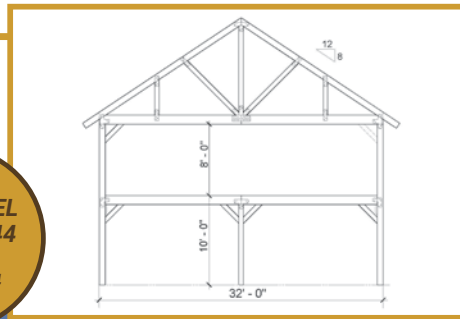

## THE ARMSTRONG 4436-G

44' x 36' 1 1/2 STORY GABLE

20' Center Section with Two 12' Lean-tos

Kit Cost: \$70,882

MAIN LEVEL  
SQ FT 1,440  
LOFT  
SQ FT 720

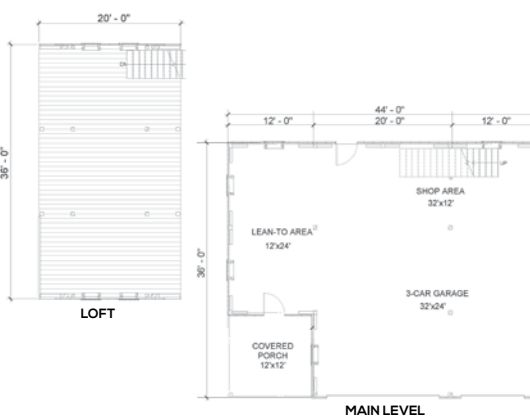
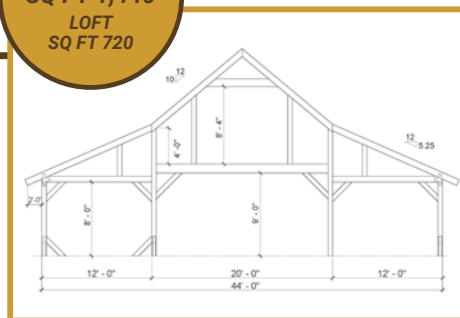

## THE KNOX 4448-GL

44' x 48' 2 STORY RAISED CENTER

20' Center Section with Two 12' Lean-tos

Kit Cost: \$111,119

MAIN LEVEL  
SQ FT 1,824  
LOFT  
SQ FT 960

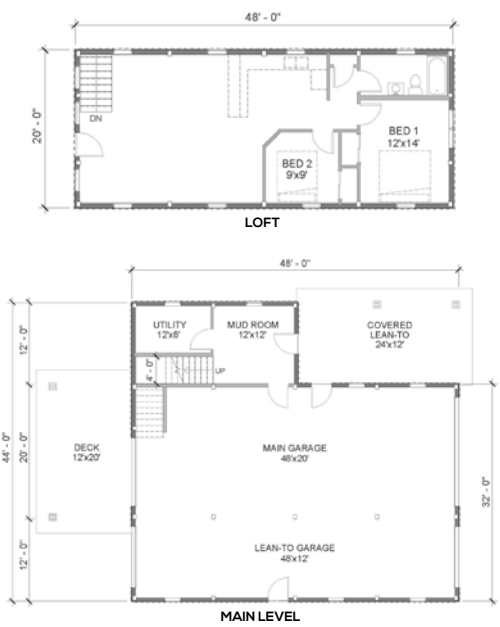
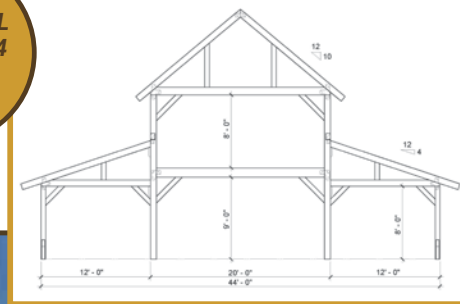

MAKE IT YOUR OWN!

Use our pre-designed kit as a starting point, then customize! See these examples of similarly sized barns with extra length added.



BUILD YOUR LEGACY

Floorplans are customizable

\*BASED ON 2024 PRICING. SUBJECT TO CHANGE.

LEGACYPOSTANDBEAM.COM 38

# THE DENTON 1628

16' x 28' 1 STORY MONOSLOPE

16' Center Section

Kit Cost: \$27,086

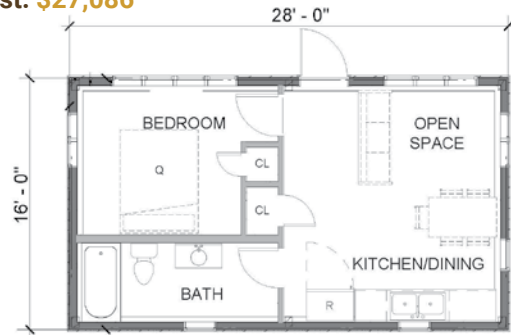

MAIN LEVEL



MAIN LEVEL  
SQ FT 448

# THE KNOX 3236

32' x 36' 1 3/4 STORY RAISED CENTER

18' Center Section with One 14' Enclosed Lean-to

Kit Cost: \$82,117

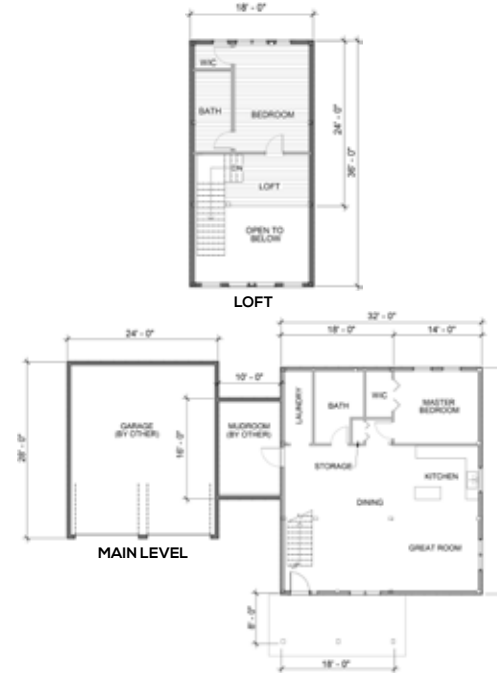

LOFT

MAIN LEVEL

MAIN LEVEL  
SQ FT 1,152  
LOFT  
SQ FT 432

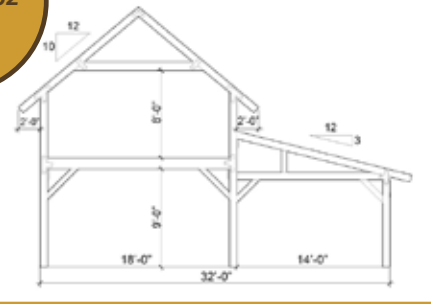

# THE KNOX 2828

28' x 28' 2 STORY RAISED CENTER

28' Center Section with 10' Porch

Kit Cost: \$79,319

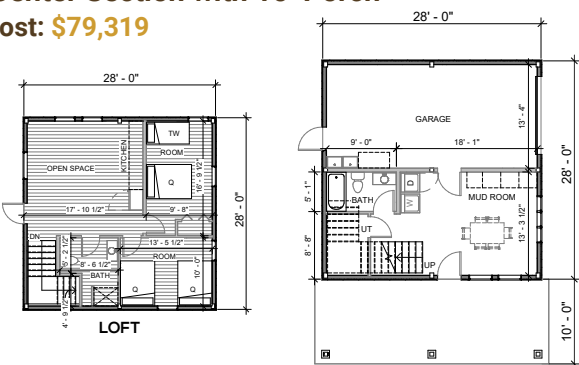

MAIN LEVEL



MAIN LEVEL  
SQ FT 784  
LOFT  
SQ FT 784

# THE ARMSTRONG 3236-LT

32' x 36' 1 3/4 STORY GABLE

32' Center Section with a 10' Open Lean-to

Kit Cost: \$84,886

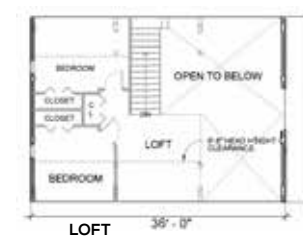

LOFT



MAIN LEVEL

MAIN LEVEL  
SQ FT 1,152  
LOFT  
SQ FT 574

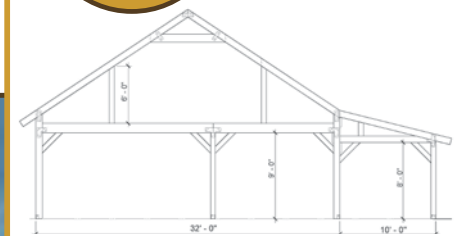

View with a different porch placement online: The Armstrong 3236-GE



# THE DENTON 3036

30' x 36' 1 STORY MONOSLOPE

20' Center Section with One 10' Enclosed Lean-to

Kit Cost: \$57,677

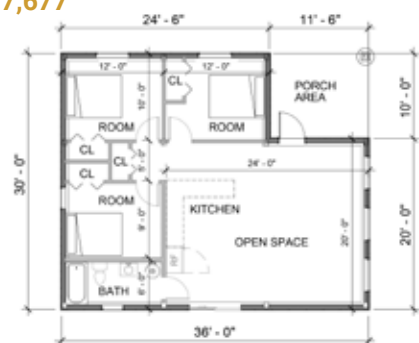

MAIN LEVEL



MAIN LEVEL  
SQ FT 965

# THE KNOX 3248

32' x 48' 2 STORY RAISED CENTER

20' Center Section with a 12' Lean-to and a 10' Wraparound Porch

Kit Cost: \$111,353

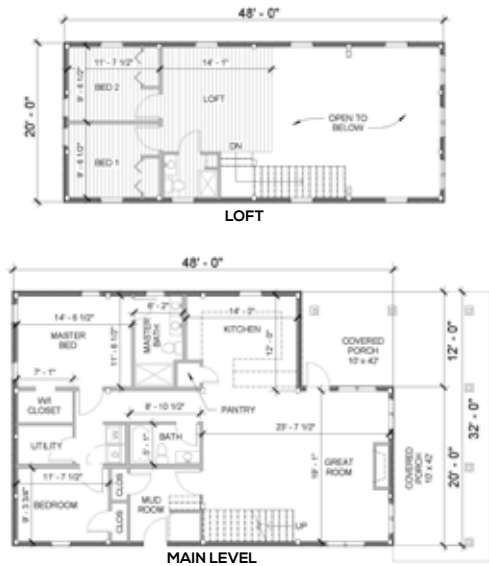

MAIN LEVEL  
SQ FT 1,392  
LOFT  
SQ FT 520

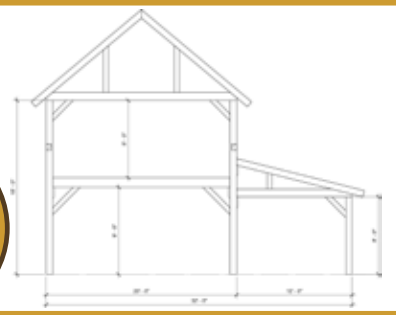

# THE DENTON 4248

42' x 48' 1 STORY MONOSLOPE

42' Center Section

Kit Cost: \$105,560

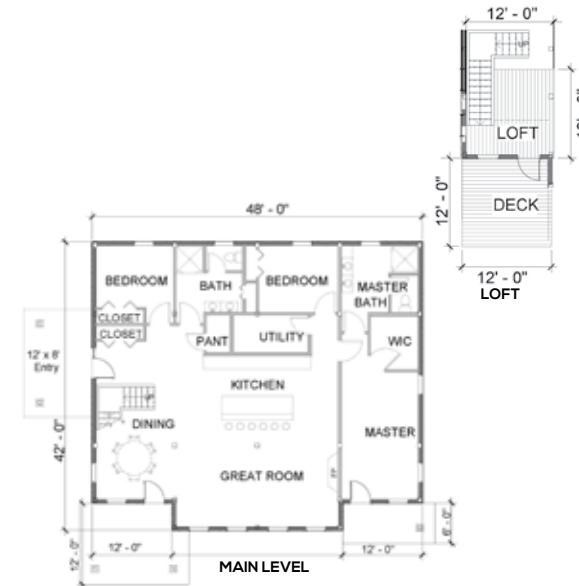

MAIN LEVEL  
SQ FT 1,920  
LOFT  
SQ FT 144

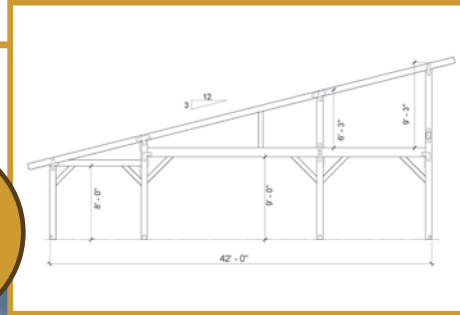

# THE ARMSTRONG 3242-GE

32' x 42' 1 1/4 STORY GABLE

32' Center Section with 8' x 28' Porch

Kit Cost: \$108,516

MAIN LEVEL  
1,344 SQ FT  
LOFT  
504 SQ FT

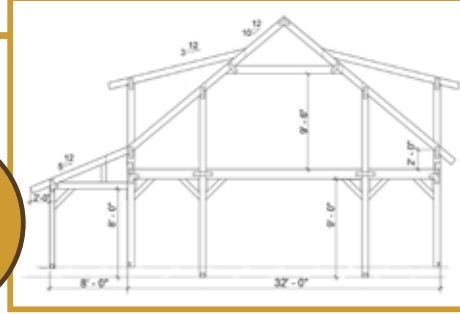

MAKE IT YOUR OWN!

Notice how the roofline is the same on these kits, but with changes as simple as which side the garage is on, or the addition of a gable entry, it takes on a much different feel!



Armstrong 3242



KDA0521

Floorplans are customizable

# THE KNOX 4848-H

48' x 48' 2 STORY RAISED CENTER

20' Center Section with Two 14' Lean-tos

Kit Cost: \$131,953

MAIN LEVEL  
SQ FT 1,968  
LOFT  
SQ FT 504

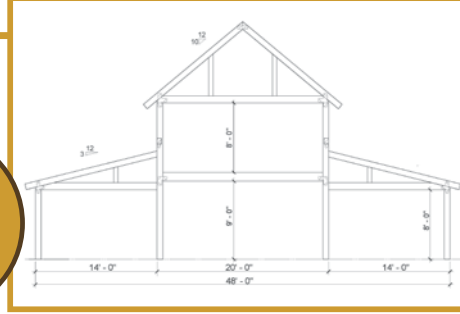

See a finished example on page 63



\*BASED ON 2024 PRICING. SUBJECT TO CHANGE.

# THE ARMSTRONG 3248

32' x 48' 1 STORY GABLE

32' Center Section with a 20' x 10' Gable Entry and a 22' x 12' Porch  
Kit Cost: \$129,798

MAIN LEVEL  
SQ FT 1,536  
LOFT  
SQ FT 948

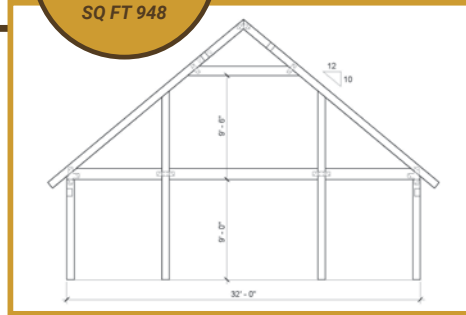

# THE KNOX 6460

24' CENTER SECTION WITH TWO 20' LEAN-TOS



# THE ARMSTRONG 3448

34' x 48' 1 1/2 STORY GABLE

34' Center Section with 8' Wraparound Porch  
Kit Cost: \$132,264

MAIN LEVEL  
SQ FT 1,632  
LOFT  
SQ FT 984

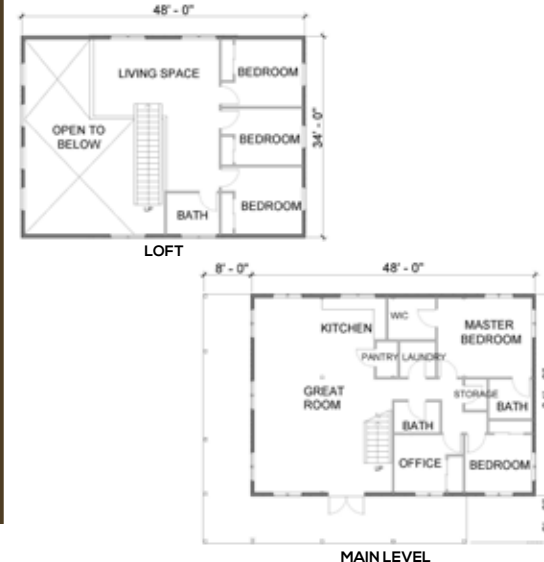
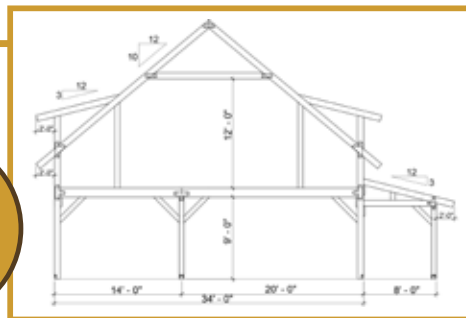

## BENT DETAILS

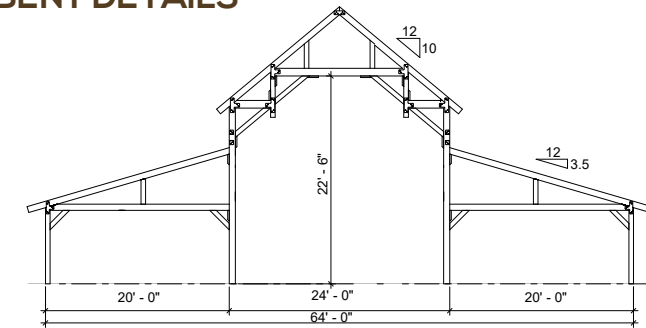

\*Kit cost includes Hammer Truss Upgrade on 3 of 6 bents

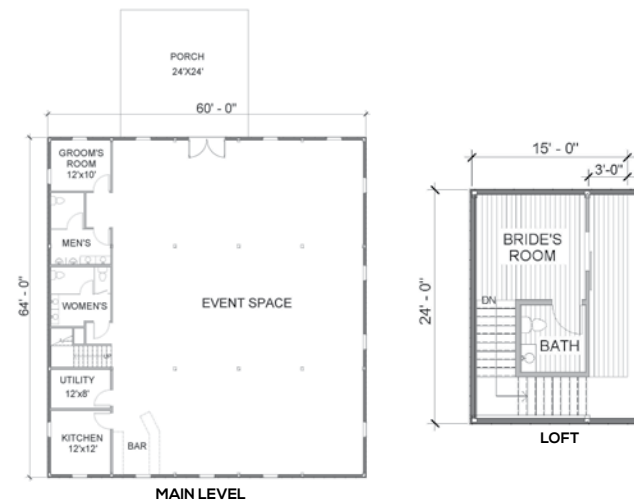

Length	Est. Seating Capacity	Main Level Sq Ft	Kit Cost
48' Long (-12')	154	3,072	\$194,940
60' Long (Pictured)	205	3,840	\$226,298
72' Long (+12')	256	4,608	\$257,656
84' Long (+12')	307	5,376	\$289,924
96' Long (+12')	358	6,144	\$322,193

\*BASED ON 2024 PRICING. SUBJECT TO CHANGE.

## THE ARMSTRONG 6872

36' CENTER SECTION WITH TWO 16' LEAN-TOS

## THE KNOX 6496

40' CENTER SECTION WITH TWO 12' LEAN-TOS



### BENT DETAILS

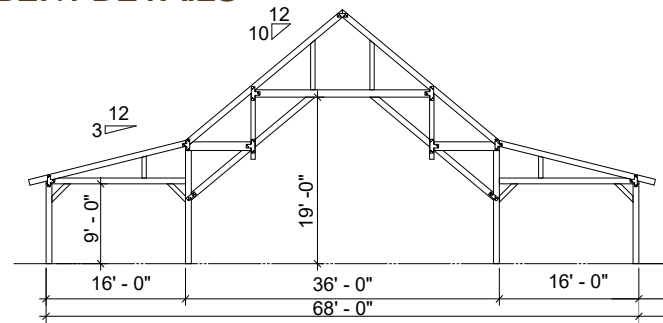

\*Kit cost includes Hammer Truss Upgrade on 5 of 7 bents

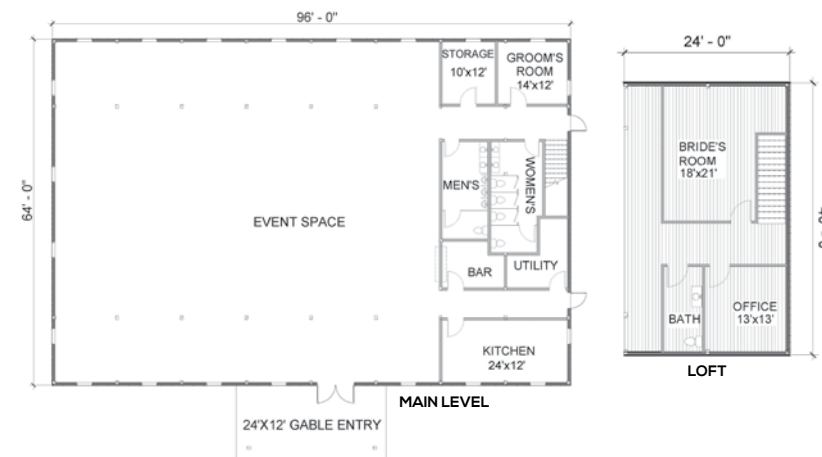

### BENT DETAILS

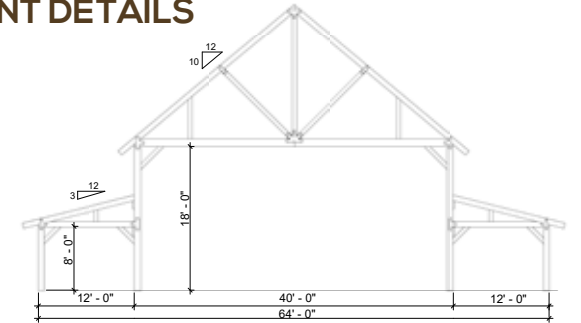

\*Kit cost includes King Post Truss with Struts Upgrade on 7 of 9 bents

Length	Est. Seating Capacity	Main Level Sq Ft	Kit Cost
60' Long (-12')	208	4,080	\$215,246
72' Long (Pictured)	250	4,896	\$248,080
84' Long (+12')	292	5,712	\$281,642
96' Long (+12')	334	6,528	\$315,205
108' Long	376	7,344	\$348,767

Length	Est. Seating Capacity	Main Level Sq Ft	Kit Cost
72' Long (-12')	205	4,608	\$273,697
84' Long (-12')	256	5,376	\$308,177
96' Long (Pictured)	307	6,144	\$342,656
108' Long (+12')	358	6,912	\$377,136
120' Long (+12')	409	7,680	\$411,615





# THE KNOX 6696

30' CENTER SECTION WITH TWO 18' LEAN-TOS



Like this kit?  
Call for info on  
JST0918



# THE HUTCHINSON 7296

40' CENTER SECTION WITH TWO 16' LEAN-TOS

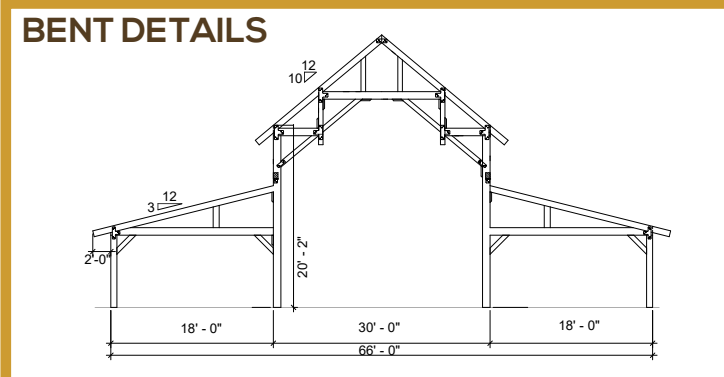
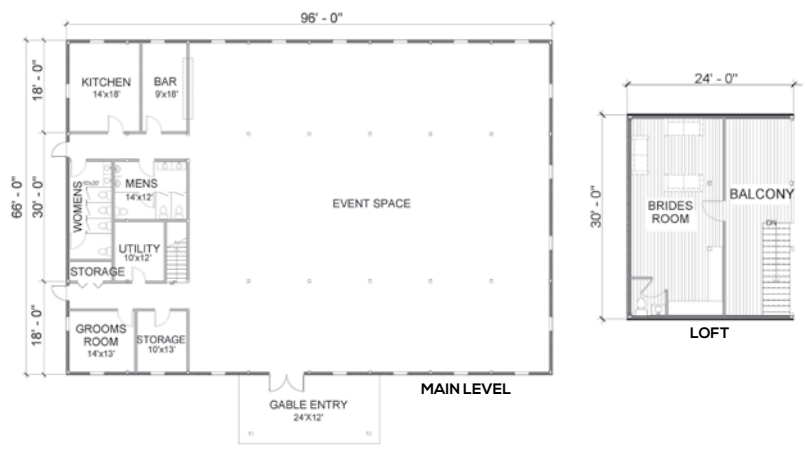

\*Kit cost includes Hammer Truss Upgrade on 5 of 9 bents

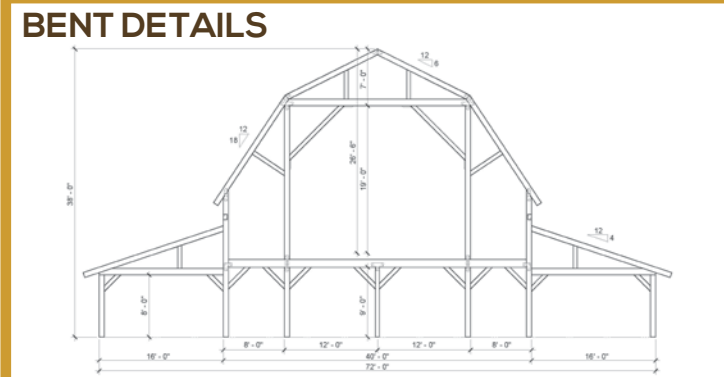

\*Kit cost includes Hammer Truss Upgrade on 4 of 9 bents

Length	Est. Seating Capacity	Main Level Sq Ft	Kit Cost
84' Long (-12')	256	5,544	\$295,392
96' Long (Pictured)	307	6,336	\$328,714
108' Long (+12')	358	7,128	\$362,036
120' Long (+12')	409	7,920	\$395,359
132' Long (+12')	460	8,712	\$428,681

Length	Est. Seating Capacity	Main Level Sq Ft	Kit Cost
72' Long (-12')	204	5,184	\$302,388
84' Long (-12')	262	6,048	\$343,346
96' Long (Pictured)	320	6,912	\$384,304
108' Long (+12')	377	7,776	\$425,262
120' Long (+12')	435	8,640	\$466,219



FEATURED BARN PROJECT

# THE ARMSTRONG - LAR1016

46' x 36' 1/2 STORY GABLE

22' Center Section with Two 12' Enclosed Lean-tos

MAIN LEVEL  
1,512 SQ FT  
LOFT  
792 SQ FT

FEATURED BARN PROJECT

# THE ARMSTRONG - JRE0220

34' x 48' 1/2 STORY GABLE

22' Center Section with a 12' Enclosed Lean-to

MAIN LEVEL  
1,632 SQ FT  
LOFT  
528 SQ FT

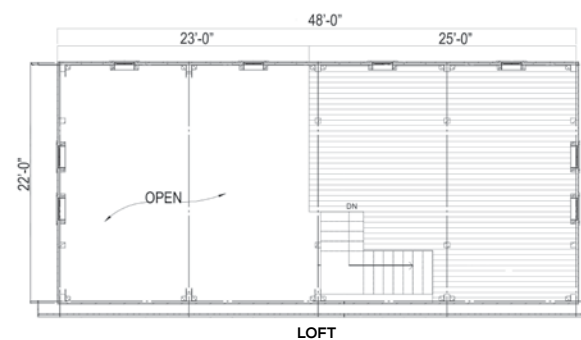
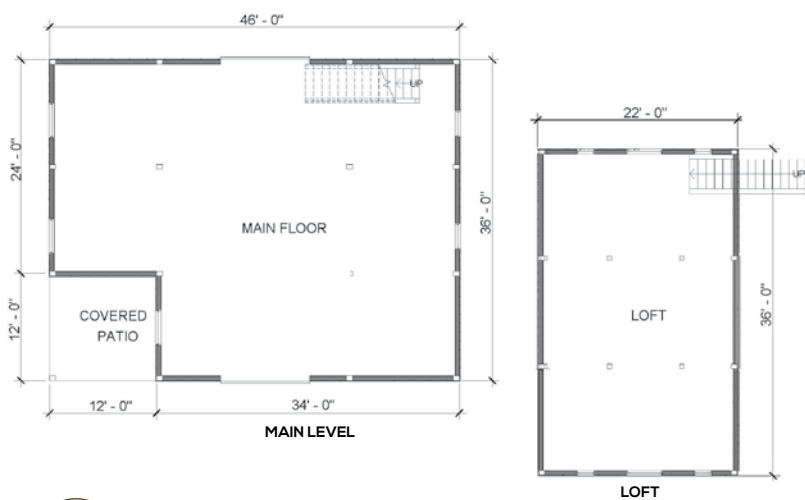
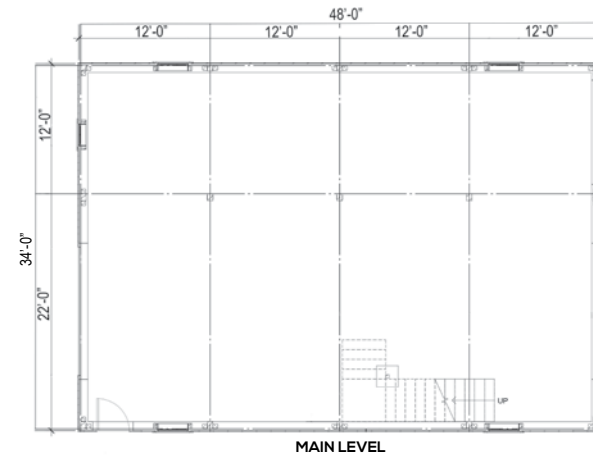

Call or visit us online for more examples

[www.legacypostandbeam.com](http://www.legacypostandbeam.com)



FEATURED BARN PROJECT

# THE KNOX - LBO1221

48' x 48' 2 STORY RAISED CENTER

24' Center Section with Two 12' Enclosed Lean-tos and Two 12' Open Lean-tos

MAIN LEVEL  
2304 SQ FT  
LOFT  
336 SQ FT

FEATURED BARN PROJECT

# THE GRAYSON - JW10621

44' x 40' 1 1/2 STORY SALTBOX

44' Center Section

MAIN LEVEL  
1,760 SQ FT  
LOFT  
1,250 SQ FT

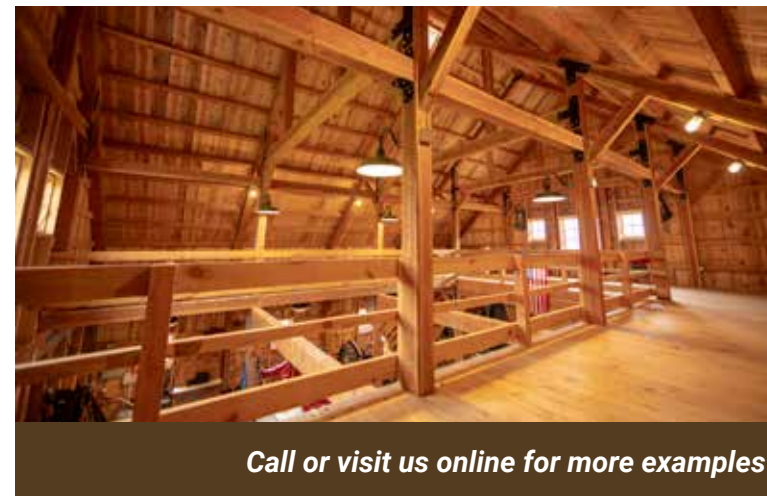
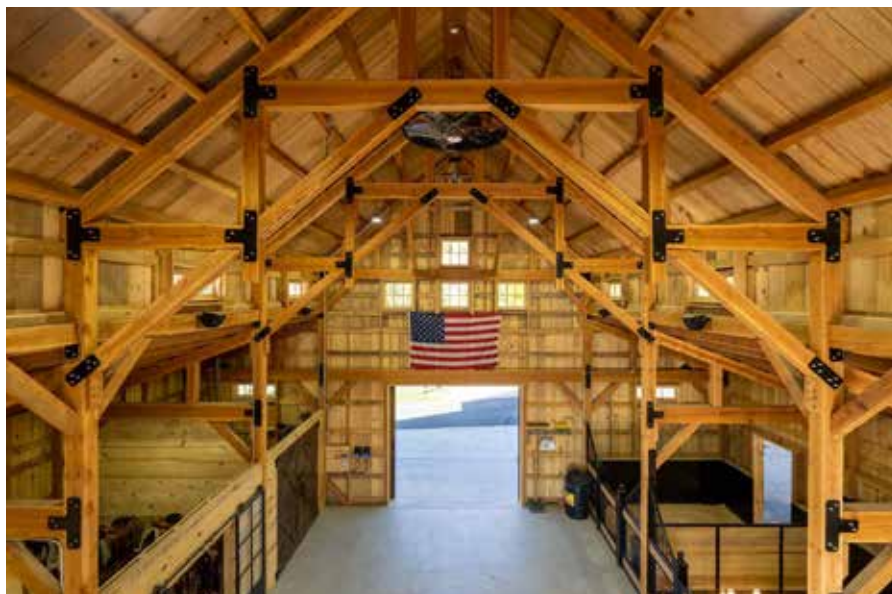
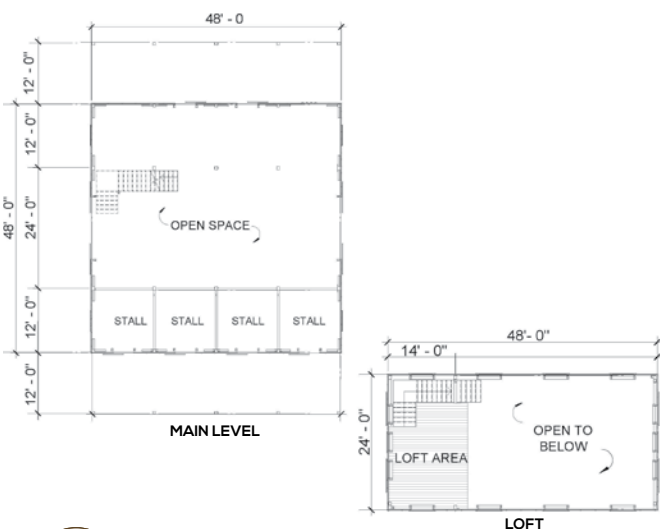
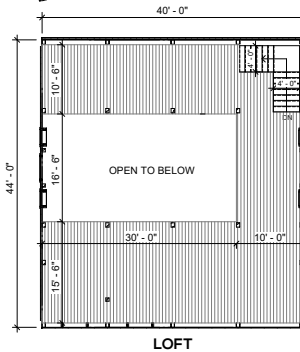
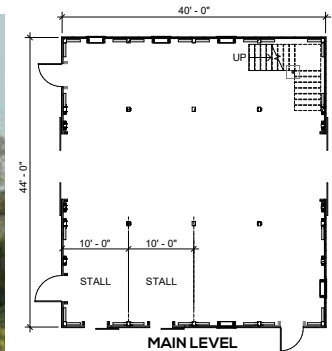
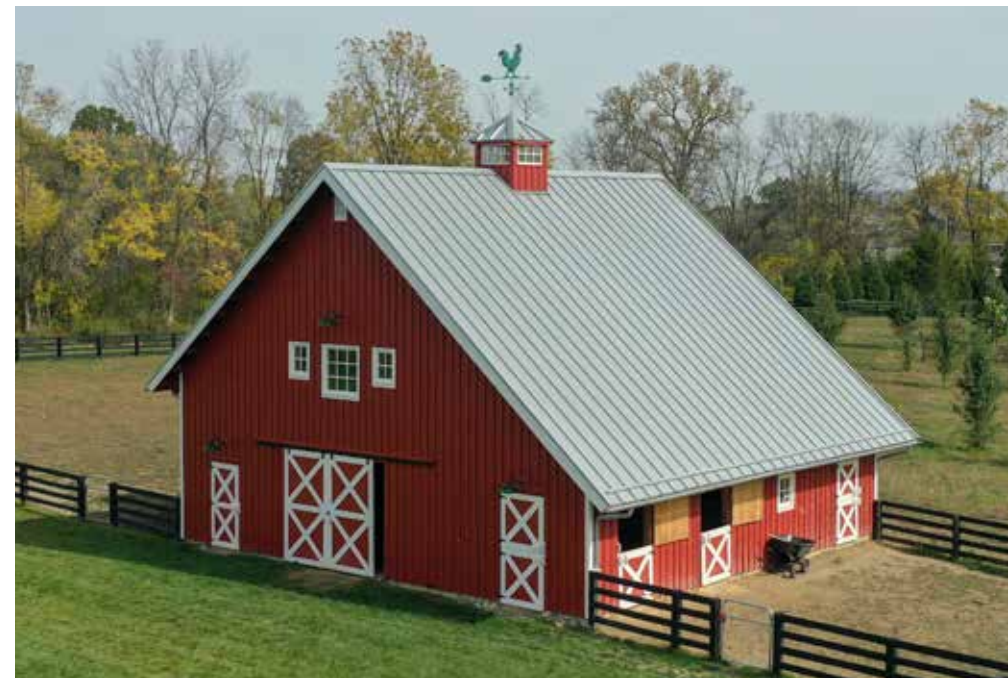
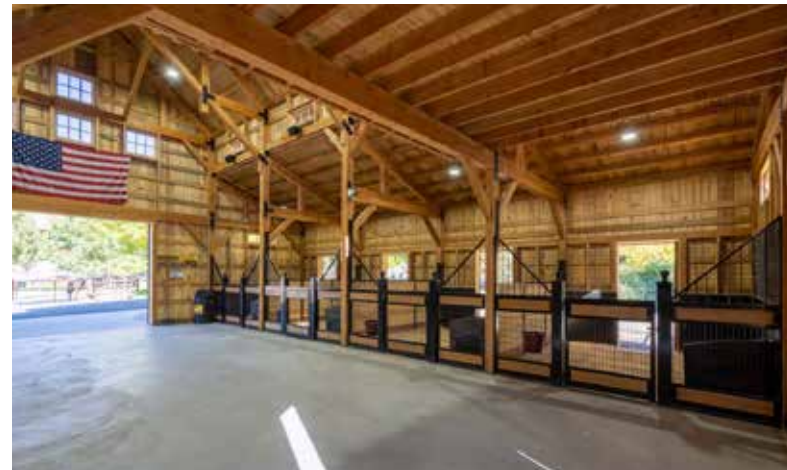

Call or visit us online for more examples

[www.legacypostandbeam.com](http://www.legacypostandbeam.com)

FEATURED BARN PROJECT

# THE KNOX- MSW0918

52' x 72' 2 STORY RAISED CENTER

24' Center Section with Two 14' Enclosed Lean-tos

MAIN LEVEL  
3,240 SQ FT  
LOFT  
1,200 SQ FT

FEATURED BARN PROJECT

# THE HUTCHINSON - VJ00616

54' x 84' 1 1/2 STORY GAMBREL

40' Center Section with a 14' Partially Enclosed Lean-to

MAIN LEVEL  
3,864 SQ FT  
LOFT  
3,360 SQ FT

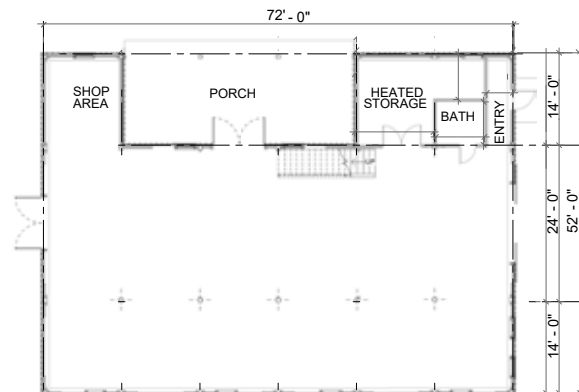

MAIN LEVEL

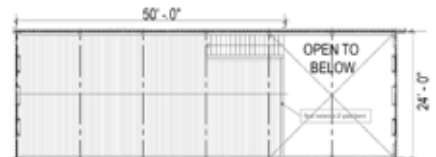

LOFT

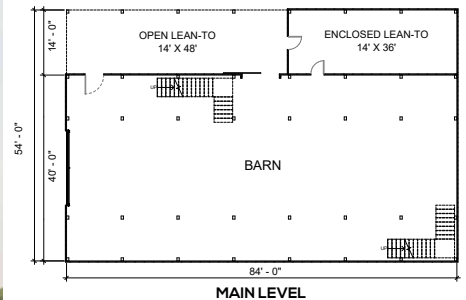

MAIN LEVEL

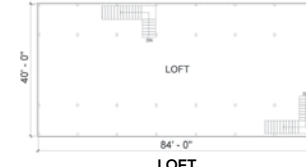

LOFT

Call or visit us online for more examples

[www.legacypostandbeam.com](http://www.legacypostandbeam.com)



 **BUILD YOUR LEGACY**

FEATURED BARN WITH LIVING SPACE PROJECT

# THE ARMSTRONG - MH00420

26' x 36' 1/2 STORY GABLE

26' Center Section

MAIN LEVEL  
936 SQ FT  
LOFT  
936 SQ FT

FEATURED BARN WITH LIVING SPACE PROJECT

# THE ARMSTRONG - MCA0517

62' x 72' 1/2 STORY GABLE

32' Center Section with Two 15' Lean-tos

MAIN LEVEL  
4,464 SQ FT  
LOFT  
768 SQ FT

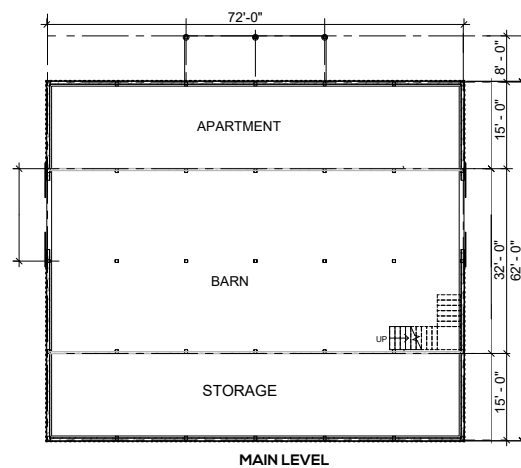
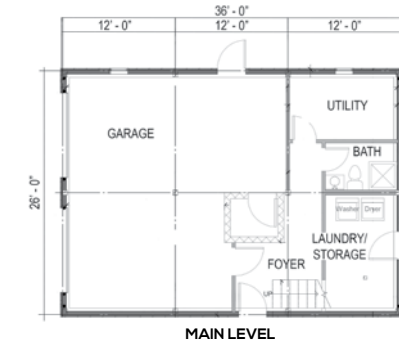

Call or visit us online for more examples

[www.legacypostandbeam.com](http://www.legacypostandbeam.com)

 **BUILD YOUR LEGACY**

FEATURED HOME PROJECT

# THE ARMSTRONG - JFR0718

40' x 36' 1/2 STORY GABLE

28' Center Section with 12' Enclosed Lean-to

MAIN LEVEL  
864 SQ FT  
LOFT  
480 SQ FT

FEATURED HOME PROJECT

# THE KNOX - DCH0918

32' x 36' 1 3/4 STORY RAISED CENTER

18' Center Section with a 14' Lean-to

MAIN LEVEL  
1,152 SQ FT  
LOFT  
432 SQ FT

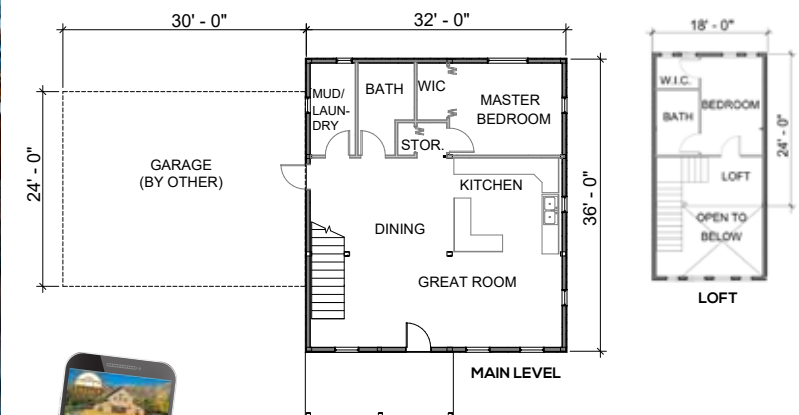
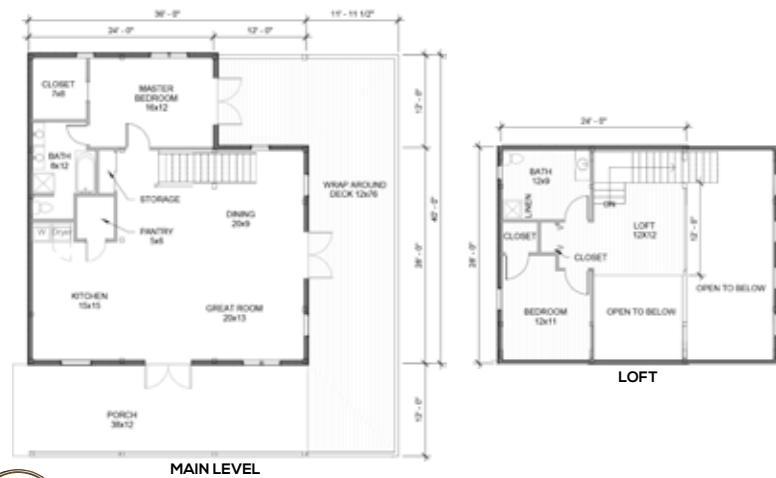

Call or visit us online for more examples

[www.legacypostandbeam.com](http://www.legacypostandbeam.com)



FEATURED HOME PROJECT

# THE ARMSTRONG - EHE0420

46' x 36' 1/2 STORY GABLE

22' Center Section with Two 12' Enclosed Lean-tos

MAIN LEVEL  
1,512 SQ FT  
LOFT  
448 SQ FT

FEATURED HOME PROJECT

# THE ARMSTRONG - KDA0521

32' x 42' 1/4 STORY GABLE

32' Center Section

MAIN LEVEL  
1,344 SQ FT  
LOFT  
726 SQ FT



Based on our Armstrong 4436-H Pre-Designed Kit

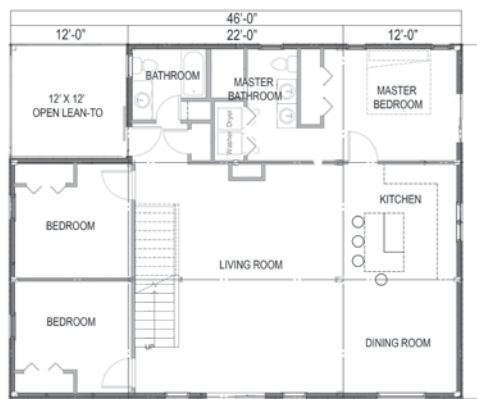

MAIN LEVEL



LOFT

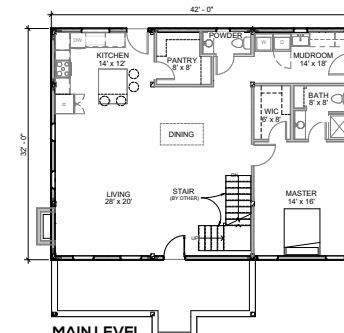

MAIN LEVEL

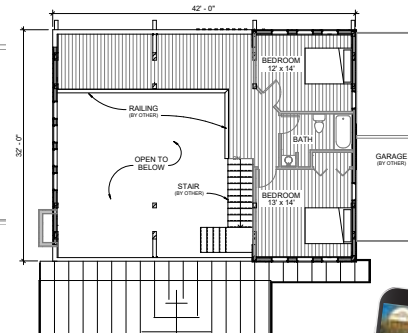

LOFT

Call or visit us online for more examples

[www.legacypostandbeam.com](http://www.legacypostandbeam.com)



FEATURED HOME PROJECT

# THE ARMSTRONG - JMO1019

42' x 42' 1/2 STORY GABLE

34' Center Section with One 8' Partially Enclosed Lean-to

MAIN LEVEL  
1,428 SQ FT  
LOFT  
840 SQ FT

FEATURED HOME PROJECT

# THE ARMSTRONG - MAS0918

52' x 38' 1/2 STORY GABLE

22' Center Section with Two 15' Lean-tos

MAIN LEVEL  
1,976 SQ FT  
LOFT  
308 SQ FT

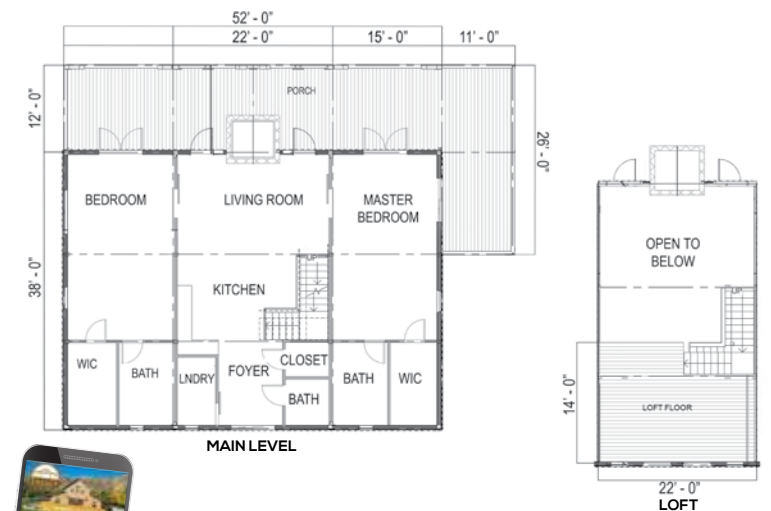

Call or visit us online for more examples

[www.legacypostandbeam.com](http://www.legacypostandbeam.com)



FEATURED HOME PROJECT

# THE KNOX - BMO1215

36' x 48' 2 STORY RAISED CENTER

24' Center Section with One 12' Enclosed Lean-to and One 12' Open Lean-to Porch

MAIN LEVEL  
1,728 SQ FT  
LOFT  
576 SQ FT

FEATURED HOME PROJECT

# THE ARMSTRONG - JEN0416

30' x 48' 1 1/2 STORY GABLE

30' Center Section with 12' Porch

MAIN LEVEL  
1,440 SQ FT  
LOFT  
1,080 SQ FT

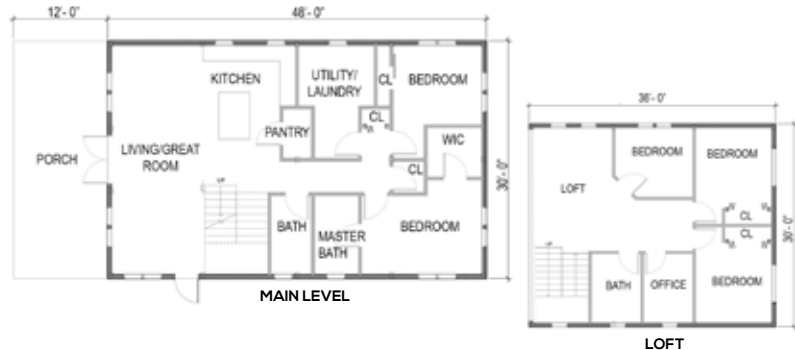

Call or visit us online for more examples

[www.legacypostandbeam.com](http://www.legacypostandbeam.com)

FEATURED HOME PROJECT

# THE BANDERA - CTR0919

36' x 50' 1 1/2 STORY GABLE COMBINATION

36' x 38' 1 Story Gable & 20'x 12' 1 1/2 Story Gable

MAIN LEVEL  
1,536 SQ FT  
LOFT  
1,016 SQ FT

FEATURED HOME PROJECT

# THE BANDERA - SMU1119

36' x 48' 2 STORY COMBINATION

24' x 36' Raised Center with a 36' x 24' Gable

MAIN LEVEL  
1,728 SQ FT  
LOFT  
864 SQ FT

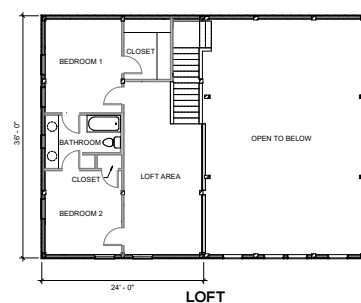
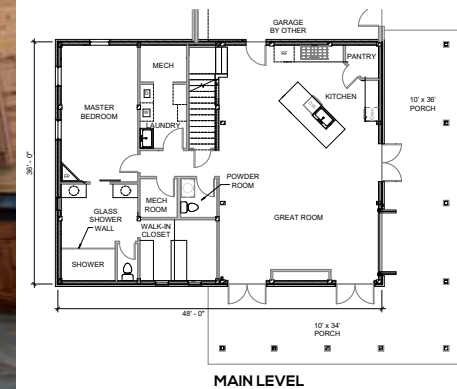
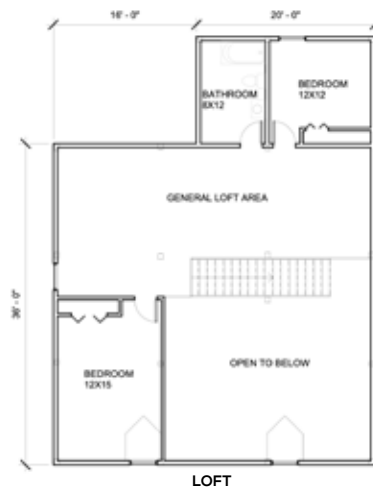
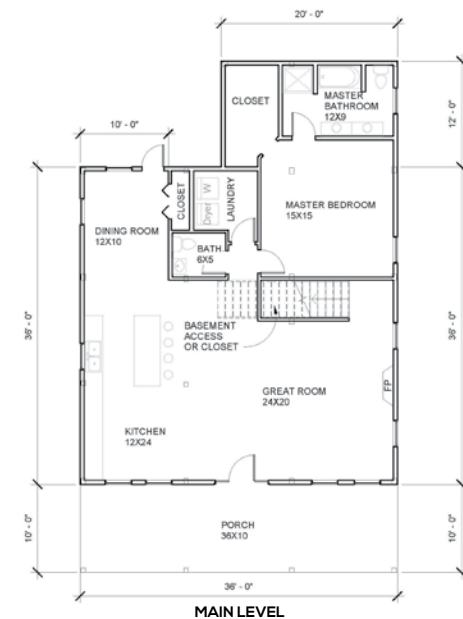

Call or visit us online for more examples

[www.legacypostandbeam.com](http://www.legacypostandbeam.com)



FEATURED HOME PROJECT

# THE ARMSTRONG - LLE0517

40' x 48' 1 1/2 STORY GABLE

40' Center Section with 8' Wraparound Porch

MAIN LEVEL  
1,920 SQ FT  
LOFT  
1,176 SQ FT

FEATURED COMMERCIAL PROJECT

# THE ARMSTRONG - JZA1019

46' x 36' 1 1/2 STORY GABLE

22' Center Section with Two 12' Enclosed Lean-tos

MAIN LEVEL  
1,512 SQ FT

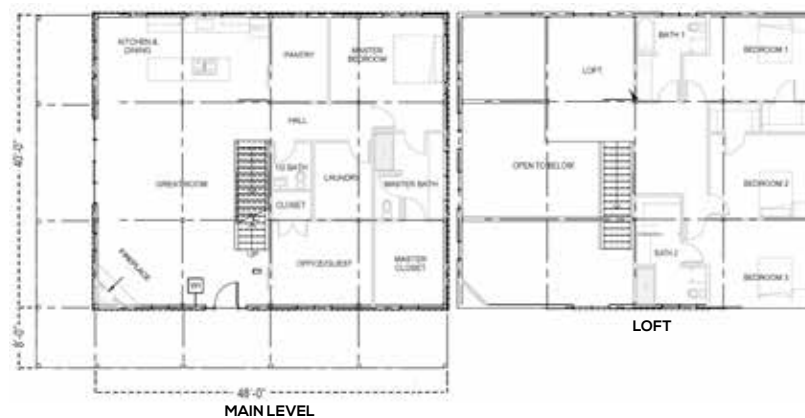

Call or visit us online for more examples

[www.legacypostandbeam.com](http://www.legacypostandbeam.com)

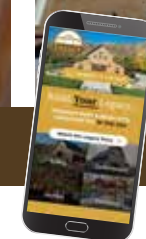

FEATURED COMMERCIAL PROJECT

# THE KNOX - SMO0217

48' x 84' 2 STORY RAISED CENTER

24' Center Section with Two 12' Enclosed Lean-tos & Two 8' Open Lean-to Porches  
Estimated Seating Capacity: 200 at rounds

MAIN LEVEL  
4,032 SQ FT  
LOFT  
648 SQ FT

FEATURED COMMERCIAL PROJECT

# THE KNOX - CBB0621

80' x 72' 2 STORY RAISED CENTER

36' Center Section with Two 22' Lean-tos

MAIN LEVEL  
4,968 SQ FT

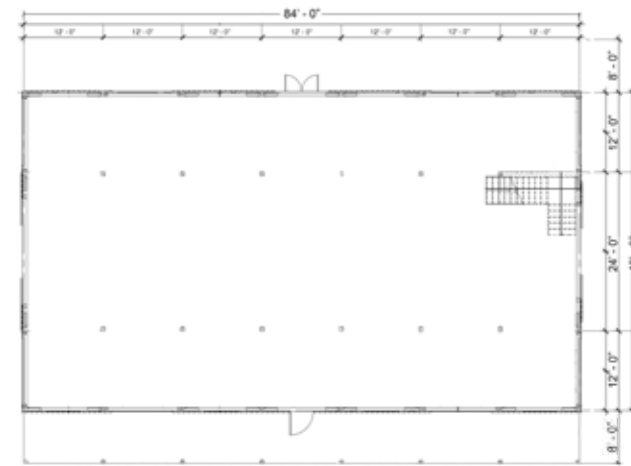

MAIN LEVEL

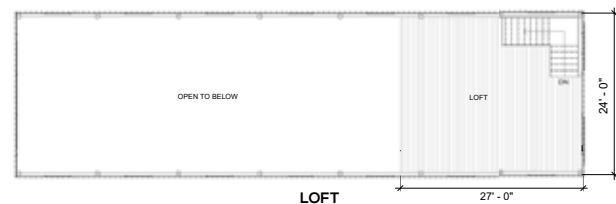

LOFT

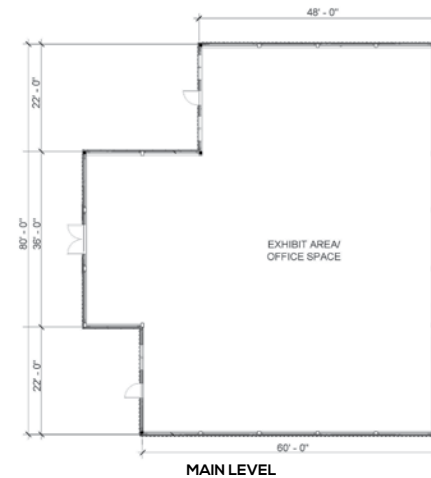

MAIN LEVEL



Call or visit us online for more examples

[www.legacypostandbeam.com](http://www.legacypostandbeam.com)



FEATURED COMMERCIAL PROJECT

# THE KNOX - GJ00216

64' x 132' 2 STORY RAISED CENTER

24' Center Section with Two 20' Enclosed Lean-tos  
Estimated Seating Capacity: 400 at rounds

MAIN LEVEL  
7,368 SQ FT  
LOFT  
576 SQ FT

FEATURED COMMERCIAL PROJECT

# THE HUTCHINSON - CSC1218

64' x 132' 1 1/2 STORY GAMBREL

40' x 132' Gambrel with Two 12' Enclosed Lean-tos & 20' x 2' Gambrel Vestibule  
Estimated Seating Capacity: 400 at rounds

MAIN LEVEL  
8,488 SQ FT  
LOFT  
960 SQ FT

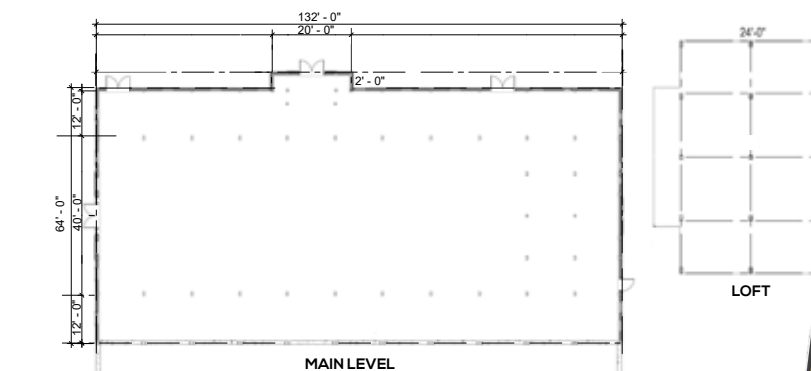
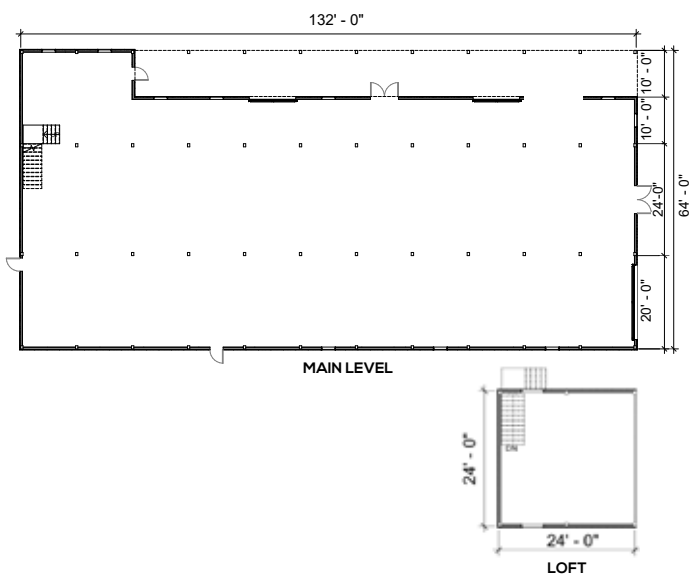
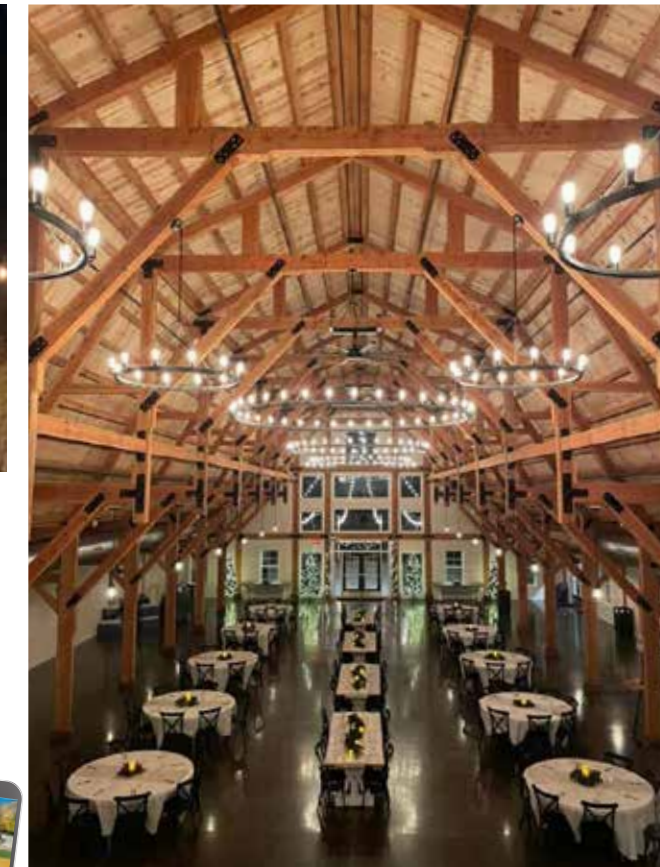

Call or visit us online for more examples

[www.legacypostandbeam.com](http://www.legacypostandbeam.com)

# TAKE THE NEXT STEP

STEP  
01

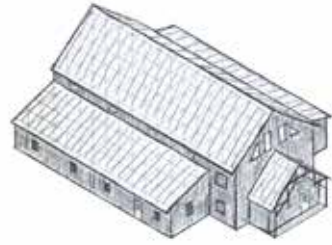

## IDEA

It all starts with an idea! Whether it's a sketch on a napkin, a concept found online, or blueprints you have in hand, our team is here to help turn your ideas and dreams into a reality.

The initial discussions with your Legacy Post & Beam representative will start with mapping out your ideas, budget, and time frame. From there, we can outline the kit that meets your needs and get started on the ordering process.

STEP  
02



## DESIGN

Let the fun begin! Now that you've worked with your Legacy Post & Beam representative on the basics of your kit, we are ready to make it official and get started on the specifics. A 20% down payment is due at this time, which allows us to get started on CAD drawings.

You will work closely with your Legacy Post & Beam Project Manager over the next few weeks to months (depending on the number of revisions needed). Then, when everything is finalized, a 50% payment is due and the production phase begins.



STEP  
03

## HANDCRAFT

The artisan craftsmanship is underway! During this phase, our timber frame experts begin handcrafting your kit in our production facility. Doing this inside a controlled environment with specialized equipment allows an increased level of accuracy and precision.

STEP  
04



## DELIVER

Headed for home! The materials of your kit will be packaged on a semi-truck and delivered to your job site. During this phase, you'll work with your Production Manager to schedule a delivery date that works well for you and your builder. When the kit is delivered, the remaining 30% payment is due.

STEP  
05



## SUPPORT

See the bents soar! During the construction phase, you will get to watch your kit transform from packaged bents into a beautiful building. Our team will be available to support you and your builder throughout the construction process.

# FREQUENTLY ASKED QUESTIONS

## Can you ship to my area?

If you live in the US or Canada, the answer is yes! We ship kits all across the Continental US and can make arrangements to ship to Alaska and Canada.

## I don't see exactly what I am looking for in this catalog, are there other options?

Yes! Every kit we send out is unique. Even our pre-designed kits come with customization options. All we need is a starting point for what you are looking for and we can work from there.

## What is a standard timeline?

On average, our kits take between four to six months to go from the idea phase to delivery. The biggest variance comes in the design phase, as this depends on the number of revisions needed. We are always willing to work within necessary timelines, so if you have a specific need, contact us to discuss.

## Do you do the onsite construction?

Legacy provides the post and beam kit but does not do any of the onsite building. All of our kits are designed to be simple for contractors to erect without previous post and beam experience. Most of our customers utilize a local general contractor to do the onsite work. We also have a network of contractors throughout the US that we can connect you with once we know your build location and have the general scope of your project outlined. Finally, each year, we have a handful of customers build the kits themselves.

## What type of foundation is needed?

A post and beam kit can be built upon any common foundation: a slab, basement, pier, crawl space, etc.

## Do you do material orders?

Yes! The items listed on our standard kit contents and accessories pages are also available on an a-la-carte/piece-by-piece basis. This includes Douglas fir beams and our interior/exterior siding. Contact us for price/availability information.

## Do your kits come with a warranty?

Yes! Our kits come with an industry standard one-year limited warranty. Additionally, we take steps to ensure we offer the highest quality post and beam kits on the market to avoid the need to redeem a warranty (we'd rather do it right the first time)! This is reflected in our choice of wood species for all load-bearing structural bent-work materials, which is kiln-dried Douglas fir. Also, all standard building plans are designed to withstand wind loads of 90 mph, and snow loads of 35 lbs/sq ft and can be engineered to fit local requirements when necessary.

## Do you offer financing?

We do not offer financing directly, but can help you through this process.

## What is your payment policy?

A 20% deposit is required to place an order for all post and beam kits. The deposit payment plus a signed order form locks in your pricing for 12 months. You have a full 60 days to cancel your order by submitting a written request. Your 20% deposit will be refunded minus any costs incurred by Legacy Post & Beam (such as CAD drawings, project management hours, engineering, etc). Once your CAD drawings are finalized, a 50% progress payment is required to start the production process. Finally, the remaining 30% payment is due upon delivery of your kit.



# BUILD YOUR LEGACY



402.317.5747  
WWW.LEGACYPOSTANDBEAM.COM